

# MEYER GAGE COMPANY

## 2019 CATALOG



## **CONTENTS**

<b>DESCRIPTION</b>	<b>PAGE</b>	<b>DESCRIPTION</b>	<b>PAGE</b>
THE ABC'S OF PLUG GAGES, GAGE MAKER'S TOLERANCE CHART .....	5	TRILOCK STYLE GAGES.....	25
PLUG GAGE USE, PFP SERVICE, PLUG GAGE TOLERANCE & SELECTION .....	6	CUSTOM PROGRESSIVE GAGES .....	26
CALIBRATION PRICE LIST .....	7	MASTER SETTING DISCS .....	27
INDIVIDUAL CLASS Z GAGE PINS INDIVIDUAL CLASS X, XX GAGE PINS .....	8	THREAD MEASURING WIRES .....	28
ENGLISH GO/NOGO GAGES WITH HANDLES, METRIC GO/NOGO GAGES WITH HANDLES .....	9	GEAR MEASURING WIRES .....	29
BLACK OXIDE COATED CLASS ZZ GO/NOGO GAGES .....	10	3-WIRE THREAD MEASURING SYSTEM .....	30-31
GAGE HANDLES & ACCESSORIES .....	11	TAPERLOCK STEEL THREAD PLUG GAGES .....	32-34
ENGLISH CLASS Z GAGE SETS .....	12	TRILOCK REVERSIBLE STEEL THREAD PLUG GAGES .....	35
ENGLISH CLASS Z LIBRARY SETS .....	13	HELICAL COIL TAPERLOCK STEEL GAGES (STI) .....	36
CLASS ZZ BLACK OX GAGE SETS .....	14	REVERSIBLE STEEL THREAD PLUG GAGES ....	37
CLASS ZZ BLACK OX LIBRARY SETS .....	15	THREAD RING GAGES (ENGLISH).....	38-39
METRIC CLASS Z GAGE SETS .....	16	TRUNCATED THREAD SETTING PLUGS.....	40-41
METRIC CLASS Z LIBRARY SETS .....	17	METRIC STEEL TAPERLOCK THREAD PLUG GAGES .....	42
ENGLISH CLASS X GAGE SETS .....	18	REVERSIBLE METRIC STEEL THREAD PLUGS .....	43
ENGLISH CLASS X LIBRARY SETS, CLASS X MG-25 SERIES .....	19	THREAD RING GAGES (METRIC) .....	44
CUSTOM LENGTH CLASS ZZ GAGES .....	20	THREAD SETTING PLUGS (METRIC).....	45
CUSTOM LENGTH CLASS X GAGES .....	21	TAPER PIPE GAGES — NPT .....	46
GAGE STORAGE ACCESSORIES, HEAVY DUTY METAL STORAGE CABINETS.....	22	TAPER PIPE GAGES — NPTF .....	47
RING GAGES .....	23	TABLE OF THREAD PITCH DIAMETER LIMITS .....	48-49
TAPERLOCK STYLE GAGES .....	24	DECIMALS & METRIC EQUIVALENTS .....	50



## WARRANTY:

---

Meyer Gage warrants all gages for 30 days from date of shipment, except in cases of customer error, misuse or mishandling. This 30 day period allows ample time for all gages to be inspected for any manufacturing inaccuracies. MEYER GAGE MAKES NO OTHER WARRANTIES OR CONDITIONS ON THE PRODUCTS, EXPRESS, IMPLIED, OR STATUTORY AND MEYER GAGE HEREBY EXPRESSLY DISCLAIMS ALL OTHER WARRANTIES INCLUDING, WITHOUT LIMITATION, THE IMPLIED WARRANTIES OF MERCHANTABILITY AND FITNESS FOR A PARTICULAR PURPOSE

## CERTIFICATIONS:

---

Contact us when you need a quote for calibration services or view our price list on page 7. We will gladly provide you a copy of our laboratory scope and uncertainties. The laboratory environment is maintained at 68° degree Fahrenheit (+/- 0.5°) 24/7 365 days a year. The laboratory has successfully completed an A2LA evaluation process and accreditation has been granted Certificate Number 3340.01 per ISO/IEC 17025:2005 standards

## Terms of sale: CONDITIONS:

---

In the event of nonconforming or defective goods or of any claimed loss or damage, buyer's sole remedy and measure of damages shall be the return of the within goods and repayment of the purchase price, or the replacement of nonconforming or defective goods or parts. In no event shall buyer be entitled to consequential damages.



# The ABC's of Plug Gages

## The ABC's of Plug Gages

Plug Gage Measuring - the art of using pre-sized precision metal plugs to determine the acceptability of diameters of drilled or machined holes.

**Go/NOGO Measurement** - A GO gage is used to check the lower limit of a hole. A NOGO gage is used to check the upper limit of a hole. If the GO gage enters the hole and the NOGO gage is unable to enter, the design specifications of the hole have been met.

**Uses** - for precision GO/NOGO measuring of hole sizes and depths, checking hole location and distance, and setting micrometers. All gages are uniformly 2" long with ground ends, allowing you to use both ends for increased gage life. Gages are Carbon Chrome Alloy Steel (grade 52100 bearing quality steel) and heat treated to a 60-62 Rockwell C hardness. All of our products come with a Certificate of Class Conformance, traceable to NIST (National Institute for Standards Technology). The size and "+" (GO) or "-" (NOGO) are laser etched with a Meyer Exclusive Serial Number feature to ensure traceability on your shop floor on all gages that are .061" and larger.

**Class ZZ Gages** - These gages have an inch tolerance of .0002" and a metric tolerance of .005mm. They are practical where good precision and speed are important.

**Class Z Gages** - These gages have an inch tolerance of .0001" and a metric tolerance of .0025mm. They are one half the deviation of the ZZ, for a better fit.

**Class X Gages** - These gages are available with an inch tolerance of .00004" and a metric tolerance of .001mm. These gages are used where greater precision is needed.

**Class XX Gages** - These gages have an inch tolerance of .00002" and a metric tolerance of .0005mm. They are one half of the deviation of the X. Great for your most critical needs.

**Length and Finish** - All gages are 2 inches or 51mm long with ground ends for long life.

**52100 Steel** - This is bearing quality, Carbon Chrome Alloy Steel heat treated to 60-62 Rockwell C hardness and is considered the preferred material for the highest quality plug gages.

**Certificate of Class Conformance** - Assurance issued with each shipment of quality gages that conformance characteristics are traceable to NIST.

**NIST** - National Institute of Standards and Technology

**Serial Number Etching** - A feature that is exclusive to Meyer Gages and essential in assuring traceability on the shop floor on all gages that are 0.061" and larger.

## Information on How to Take Care of your Meyer Gage

**Clean the part before gaging.** Get rid of dirt, coolant, and chips.  
**Protect the gage from damage.** Nicks and burrs allow inaccurate results.

**Do not force the gage.** Use light pressure.  
**Keep gages clean and oiled.** This increases wear life.

**Avoid handling gaging surfaces.** Fingerprints cause rust.

## Gage Maker's Tolerance Chart

Plain Plug, Plain Ring & Master Gage Tolerances

Range (English)	XXX	XX	X	Y	Z	ZZ
.005" to .8250"	.000010	.000020"	.000040"	.000070"	.000100"	.000200
.8251" to 1.5100"	.000015	.000030"	.000060"	.000090"	.000120"	.000240"
1.5101" to 2.5100"	.000020	.000040"	.000080"	.000120"	.000160"	.000320"
2.5101" to 4.5100"	.000025	.000050"	.000100"	.000150"	.000200"	.000400"
4.5101" to 6.5100"	.000033	.000065"	.000130"	.000190"	.000250"	.000500"
6.5101" to 9.0100"	.000040	.000080"	.000160"	.000240"	.000320"	.000640"
9.0101" to 12.2600"	.000050	.000100"	.000200"	.000300"	.000400"	.000800"
Range (METRIC)	XXX	XX	X	Y	Z	ZZ
0.21mm to 21.00mm	.00025mm	.00051mm	.00102mm	.00178mm	.00254mm	.00508mm
21.01mm to 38.00mm	.00038mm	.00076mm	.00152mm	.00229mm	.00305mm	.00610mm
38.01mm to 64.00mm	.00051mm	.00102mm	.00202mm	.00305mm	.00406mm	.00813mm
64.01mm to 115.00mm	.00064mm	.00127mm	.00254mm	.00381mm	.00508mm	.01016mm
115.01mm to 165.00mm	.00084mm	.00165mm	.00330mm	.00483mm	.00635mm	.01270mm
165.01mm to 230.00mm	.00102mm	.00203mm	.00406mm	.00610mm	.00813mm	.01626mm
230.01mm to 300.00mm	.00127mm	.00254mm	.00508mm	.00762mm	.01016mm	.02032mm

NOTE: Cylindrical plug gage tolerance is GO (Plus) and NOGO (Minus).  
 Master cylindrical plug gage tolerance is 50% Plus, 50% Minus.  
 Master Setting Disc tolerance is 50% Plus, 50% Minus.  
 Cylindrical plain ring gage tolerance is GO (Minus) and NOGO (Plus).



## ***PLUG GAGE USE***

When using plug gages for GO NOGO inspection the GO member should fit into the work piece to indicate to the operator that the component meets the correct specifications. The NOGO member should not fit into the work piece. If it does this indicates to the operator that the component has been machined incorrectly and is out of specification.

For this reason the GO gage is usually selected close but above the lower limit size of the component and the NOGO gage is usually selected just under the high limit of the component.

For example: a component that has a size specification of 0.250" to 0.255". The GO gage in this example may be selected to be a 0.250"(+) plus gage pin and the NOGO pin gage selected as a 0.255"(-) minus plug gage.

These gages, if Class Z, will range from 0.2500" to 0.2501" for the GO, and the NOGO gage will fall within a tolerance range size of 0.2550" to 0.2549".

The use of the GO and NOGO gages are used to inspect the component for a pass or fail process only, and will not measure the exact size of the hole or slot in the component. As in the above example, some "good parts" can actually fail the GO / NOGO test if they fall below the actual gage size within the tolerance or class of the gage. Below is described a standard practice for selection of the Class of tolerance gage pins with a certain tolerance component.

### ***Premium Factory Processing Service***

Meyer Gage continues to work hard to meet the expectations of our customers for product quality, responsiveness, and competitive pricing - while supplying the very finest fixed limit gages.

To further our commitment to you, we offer expediting services for orders requiring same-day processing and shipment, or rush services on custom made products. These special services will be charged a Premium Factory Processing Fee (35% of the net total order). Depending on the time, quantity and complexity of your order, shipping may be delayed until the following business day. While Meyer Gage cannot guarantee same-day shipment for all orders, we make every reasonable attempt to meet these shortened deadlines. (Shipping charges from the carrier of your choice are in addition to this service)

### ***Plug Gage Tolerance & Selection***

Standard practice in American industry is to allow 5% of the component hole tolerance for the GO gage tolerance and 5% for the NOGO gage tolerance. The GO gage, whose nominal size is at the low limit of the hole to be checked is generally given a plus tolerance in order to insure that all parts accepted fall within the product tolerance.

For the same reason the NOGO gage, whose nominal is at the high limit of the product tolerance, is given a minus tolerance. In this age of strict product liability, perhaps it is better to reject a few acceptable parts than to pass any out-of-tolerance parts. The GO gage plus tolerance and the NOGO minus tolerance have become universal in American industry and 10% of the hole tolerance (5% at each end) is sacrificed to insure that all pieces accepted are within tolerance.

There can be several reasons for using finer or coarser tolerances that the 10% rule would dictate. In a case where the production process is such that a significant number of acceptable parts are expected to fall into either of the 5% areas of product tolerance which may be rejected due to gage tolerance, a tighter tolerance should be considered. The value of these parts or the effort necessary to re-inspect them weighed against the cost of a finer gage (such as Class X, Class XX, or Class XXX) can more than justify the cost of the finer tolerance.

#### ***What Plug Gages Are...***

1. Used to inspect holes or slots for pass or fail conditions only.
2. Used as masters for setting micrometers, verniers, or calipers.

#### ***What Plug Gages Are Not...***

1. Used to measure the exact or actual size.
2. Resizing tools, or reamers.
3. Deburring tools, or clean out tools.



# Calibration List:

Date: 9/12/2013 Cert # 14882



**MEYER GAGE COMPANY INC.**  
Certificate of Calibration

Calibrated by: MEYER GAGE COMPANY, INC.  
230 BURRHAM STREET  
SOUTH WINDSOR, CT, 06074

YOUR COMPANY NAME  
123 MAIN STREET  
ANY TOWN, ST 00000-0000

Equipment: AEROL LASER XLS 40

Description: CLZ INCH CYLINDRICAL PLUG GAGES

Manufacturer: MEYER GAGE COMPANY INC.

Gage Type: CLZ

Model Number:

Temp. RH: 67.8 F ( 43.9

Cal. Interval:

Cal Date: 9/12/2013

Calibration Method Used: MEYER 01

Measurements taken using Aerial Kartrol Laser Scan Microscoper serial number XLS 40 date calibrated 06/17/2013, calibration due date 06/17/2014. Master gage pins serial number(s) MEYER-1-1, 327000-1-1, 352238-1-1 date calibrated 04/03/2011, calibration due date 04/03/2014.

Description	Tolerance	Dimension 1	Dimension 2	Dimension 3	Dimension 4	Dimension 5	Dimension 6	Dimension 7
0.1250	± 0.0005	0.125100	0.125000	0.125000	0.125000	0.125000	0.125000	0.125000
0.2500	± 0.0005	0.250100	0.250000	0.250000	0.250000	0.250000	0.250000	0.250000
0.5000	± 0.0005	0.500100	0.500000	0.500000	0.500000	0.500000	0.500000	0.500000
0.7500	± 0.0005	0.750100	0.750000	0.750000	0.750000	0.750000	0.750000	0.750000

Inspected By: Calibration Technician

Reviewed By: Calibration Technician

Page 1 of 1 Cert # 14882

## Certificate of Class/Conformance (compliance)

This certificate states that a specific gage or set of gages has been inspected by comparison with Master Gages traceable to the National Institute of Standards & Technology and found to be within the required tolerance. This certificate does not give exact size. Certificates of Conformance are available on new gages only. Certificate of Conformance certifies that a gage, as listed, is within proper tolerances and proper physical condition. (Furnished FREE with all orders from Meyer Gage)

## Calibrations Traceable to NIST and/or 17025

Certificate of Calibration (long form certificate) gives exact size to specified tolerance. Certificates of Calibration are available with new or used gages after inspection. Calibration Certificates show actual gage measurements. Each certificate is numbered to match a number we etch on the gage providing traceability between the gage and the Certificate where gage size permits.

## A2LA 17025 Certifications Per Piece

### PLUG & RINGS GAGES

	New	Customer
Class ZZ or Z Pin Set		
Class ZZ or Z Individual Pins		
Class XX or X Pin Set		
Class XX or X Individual Pins		
Master Setting Discs (per Dimension)		
Trilock Gage (all Classes)		
Taperlock Gage (all Classes)		
Progressive Gage (all Classes)		
Ring Gage (Catalog Offering)		
Custom Length Class ZZ		
Custom Length Class X		

### THREAD WIRE & GEAR WIRE PRODUCTS

	New	Customer
Thread Wire Sets (3 wires)		
Gear Wire Sets (2)		

## NIST Traceable Certifications Per Piece

### THREADED PRODUCTS

	New	Customer
Thread Plugs up to 1-1/2"		
Thread Plugs over 1-1/2" to 4"		
Thread Plugs over 4"		
Thread Rings up to 1-1/2"		
Thread Rings over 1-1/2" to 4"		
Thread Rings over 4"		

### PIPE PRODUCTS

	New	Customer
Pipe Plugs up to 2"		
Pipe Plugs over 2"		
Pipe Rings up to 2"		
Pipe Rings over 2"		



# Individual Class Z Gage Pins\*

Replace missing pins! Don't live with broken sets. We stock these replacement pins in even and half-thousand sizes for immediate shipment. All pins over 0.060"/1.51mm are laser marked with size and direction of tolerance. But we don't stop there. We've also added a serial number lasered onto each piece for traceability.

## English

.005	to	.0105
.011	to	.0605
.061	to	.5005
.501	to	.6255
.626	to	.7505
.751	to	.8325
.833	to	.9165
.917	to	1.0150



*IMPORTANT: Specify PLUS or MINUS when ordering individual members.  
\*Size increments available in 0.0005"/0.01mm*

## Metric

.22mm	to	1.51mm
1.52	to	12.71
12.72	to	15.31
15.32	to	17.81
17.82	to	20.37
20.38	to	22.05
22.06	to	23.73
23.74	to	25.41



# Individual Class X, XX Gage Pins\*

These pins have the same features as our Class Z pins, but with a 0.00004" tolerance limit and a 0.00002" roundness limit. They are great for your inspection needs or when you want to maximize your GO/NOGO tolerance limit. They're also a great way to calibrate measuring equipment, micrometers and calipers. We make all sizes for your special needs. All pins over 0.060" or 1.51 mm are laser marked with size and direction of tolerance. We've also added a serial number lasered onto each piece for traceability.

When an even tighter tolerance is needed, Meyer Gage makes XX pin gages. With a tolerance of 0.00002" and a roundness limit of 0.00001", it's our tightest tolerance yet for your most critical inspection needs. They're our best gages to calibrate your measuring equipment, micrometers and calipers. All pins over 0.060" or 1.51mm are laser marked with size and direction of tolerance. We've also added the serial number for traceability.



Inch	Class X	Class XX
.0110" to .07599"		
.0760" to .50099"		
.5010" to .74999"		
.7500" to 1.0000"		
Metric	Class X	Class XX
0.220mm to 1.909mm		
1.910mm to 12.709mm		
12.710mm to 19.029mm		
19.030mm to 25.400mm		

Please specify **PLUS** or **MINUS**. Also available **Class X, XX BILATERAL** (split tolerance). Add 25% to prices . . .



# English GO/NOGO Gages with Handle

Price Range	Diameter Range	Class Z GO		Class X GO		Class XX GO	
		Class Z GO/NOGO Ass'y. (220A)	Assembly <i>or</i> NOGO Ass'y. (225B)	Class X GO/NOGO Ass'y. (230C)	Assembly <i>or</i> NOGO Ass'y. (235D)	Class XX GO/NOGO Ass'y. (236I)	Assembly <i>or</i> NOGO Ass'y. (237J)
1	0.0110" to 0.0755"						
2	0.0760" to 0.1805"						
3	0.1810" to 0.2815"						
4	0.2820" to 0.4065"						
5	0.4070" to 0.5005"						
6	0.5010" to 0.5105"						
7	0.5110" to 0.6255"						
8	0.6260" to 0.6355"						
9	0.6360" to 0.7505"						
10	0.7510" to 0.7605"						
11	0.7610" to 0.8325"						
12	0.8330" to 0.9165"						
13	0.9170" to 1.0005"						

**Order in 4 Easy Steps:**

List Product Group ..... **Ex: 225B**  
 Price Range ..... **4**  
 Size Needed ..... **.400**  
 Choice of Plus or Minus Tol..... **Minus**

**.400" Minus Single End Assembly would be ordered as Product Group 225B, Price Range 4, Size .400" Minus**

# Metric GO/NOGO Gages with Handle

Price Range	Diameter Range (mm)	Class Z GO		Class X GO		Class XX GO	
		Class Z GO/NOGO Ass'y. (240E)	Assembly <i>or</i> NOGO Ass'y. (245F)	Class X GO/NOGO Ass'y. (250G)	Assembly <i>or</i> NOGO Ass'y. (255H)	Class XX GO/NOGO Ass'y. (256K)	Assembly <i>or</i> NOGO Ass'y. (257L)
1	0.22mm to 1.90mm						
2	1.91mm to 4.56mm						
3	4.57mm to 7.14mm						
4	7.15mm to 10.32mm						
5	10.33mm to 12.70mm						
6	12.71mm to 12.96mm						
7	12.97mm to 15.30mm						
8	15.31mm to 16.20mm						
9	16.21mm to 19.30mm						
10	19.31mm to 20.36mm						
11	20.37mm to 22.04mm						
12	22.05mm to 23.72mm						
13	23.73mm to 25.41mm						

One complete GO/NOGO gage includes: one Plus member (GO), one Minus member (NOGO), one Double End Handle with Bushings assembled.  
 GO gage includes: one Plus member with Single End Handle and Bushing assembled.  
 NOGO gage includes: one Minus member with Single End Handle and Bushing assembled.  
 GO/NOGO gages are available with special diameter or length gages, prices on request.  
 Gage Handles marked with size and direction of tolerance. \*Additional markings \$ per character.





# Black Oxide Coated Class ZZ GO/NOGO Gages

## Black OX from Meyer Gage

Gage pins with a durable protective black oxide coating.

**Example of how to order: 216B 4 .3250+**

*Black OX is a division of Meyer Gage*

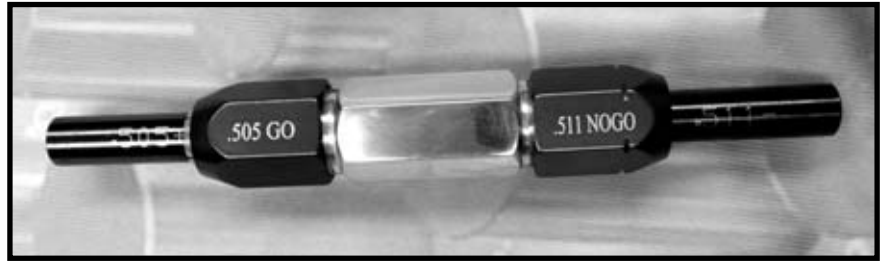

### Features Include:

- Black Oxide treatment
- Class ZZ .0002" tolerance –gages clearly marked
- No sharp edges
- All gages 2" long
- Available in 0.001" increments
- Certificate of conformance to ANSIB89.1.5-1998

### Uses:

- Measuring hole size and depth-checking locations
- GO & NOGO gaging
- Inspect holes, or slots for pass/fail conditions
- Check micrometers and calipers

### Finish

- Black OX surface treatment
- Centerless ground
- 10 micro-inch finish
- Heat treated to 60-62 Rockwell C
- Each gage with .0002" limit
- Roundness Geometry .0001" limit

Range	Description	Class ZZ	
		GO/NOGO Ass'y. (215A)	GO or NOGO Ass'y. (216B)
1	0.0110" to 0.075"		
2	0.0760" to 0.180"		
3	0.1810" to 0.281"		
4	0.2820" to 0.406"		
5	0.4070" to 0.500"		
6	0.5010" to 0.510"		
7	0.5110" to 0.625"		
8	0.6260" to 0.635"		
9	0.6360" to 0.750"		

One complete GO/NOGO gage includes:

- one Plus member (GO)
- one Minus member (NOGO)
- one Double End Handle with Bushings assembled

GO gage includes:

- one Plus member with Single End Handle and Bushing assembled

NOGO gage includes:

- one Minus member with Single End Handle and Bushing assembled

Gage Handles marked with size and direction of tolerance.

\*Additional markings \$ per character.



# Gage Handles & Accessories

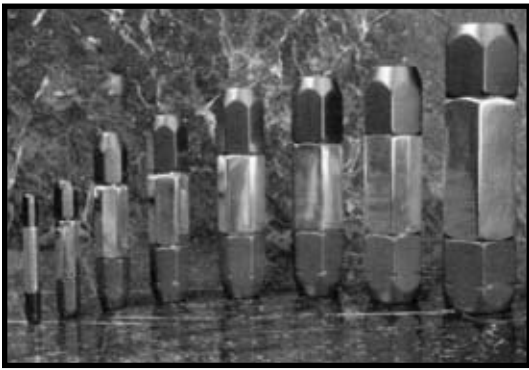

Handles furnished without bushings. Bushings sold separately (see below). Custom engraving available

Plug Gage Diameter (mm)	Double End Handle #	Single End Handle #
0.005" to 0.075" (0.13 to 1.89)	1WDE	1WSE
0.076" to 0.180" (1.90 to 4.57)	2WDE	2WSE
0.181" to 0.281" (4.58 to 7.13)	3WDE	3WSE
0.282" to 0.406" (7.14 to 10.31)	4WDE	4WSE
0.407" to 0.510" (10.32 to 12.95)	5WDE	5WSE
0.511" to 0.635" (12.96 to 16.12)	6WDE	6WSE
0.636" to 0.760" (16.13 to 19.30)	7WDE	7WSE
0.761" to 1.010" (19.31 to 25.41)	8WDE	8WSE

## English Wire type, Cylindrical Gage Bushings

1W010 thru 5W510 .....  
6W532 thru 8W1.00 .....

**MATERIAL**  
1W thru 5W ..... BRASS  
6W thru 8W ..... ALUMINUM



Range			Range			Range			Range		
Bushing#	Above	Thru	Bushing#	Above	Thru	Bushing#	Above	Thru	Bushing#	Above	Thru
1W010	.005	.010	2W131	.124	.131	4W301	.291	.301	6W579	.563	.579
1W015	.010	.015	2W138	.131	.138	4W311	.301	.311	6W594	.579	.594
1W020	.015	.020	2W145	.138	.145	4W321	.311	.321	6W610	.594	.610
1W025	.020	.025	2W152	.145	.152	4W331	.321	.331	6W625	.610	.625
1W030	.025	.030	2W159	.152	.159	4W341	.331	.341	6W635	.625	.635
1W035	.030	.035	2W166	.159	.166	4W351	.341	.351	7W656	.635	.656
1W040	.035	.040	2W173	.166	.173	4W361	.351	.361	7W672	.656	.672
1W045	.040	.045	2W180	.173	.180	4W371	.361	.371	7W688	.672	.688
1W050	.045	.050	3W188	.180	.188	4W382	.371	.382	7W704	.688	.704
1W055	.050	.055	3W196	.188	.196	4W394	.382	.394	7W719	.704	.719
1W060	.055	.060	3W204	.196	.204	4W406	.394	.406	7W735	.719	.735
1W065	.060	.065	3W212	.204	.212	5W420	.406	.420	7W750	.735	.750
1W070	.065	.070	3W220	.212	.220	5W435	.420	.435	7W760	.750	.760
1W075	.070	.075	3W228	.220	.228	5W450	.435	.450	8W781	.760	.781
2W082	.075	.082	3W236	.228	.236	5W465	.450	.465	8W812	.781	.812
2W089	.082	.089	3W244	.236	.244	5W480	.465	.480	8W843	.812	.843
2W096	.089	.096	3W252	.244	.252	5W495	.480	.495	8W875	.843	.875
2W103	.096	.103	3W261	.252	.261	5W510	.495	.510	8W906	.875	.906
2W110	.103	.110	3W271	.261	.271	6W532	.510	.532	8W937	.906	.937
2W117	.110	.117	3W281	.271	.281	6W547	.532	.547	8W968	.937	.968
2W124	.117	.124	4W291	.281	.291	6W563	.547	.563	8W1.000	.968	1.010

## Lightweight Universal Handles (No Bushings Required)



Handle No.	Range (inch)	Range (mm)
1PGHDE	.0110" - .0605"	(.28mm - 1.51mm)
2PGHDE	.0610" - .2505"	(1.52mm - 7.71mm)
3PGHDE	.2510" - .5005"	(7.72mm - 12.71mm)
4PGHDE	.5010" - .6255"	(12.72mm - 15.31mm)
5PGHDE	.6260" - .7505"	(15.32mm - 17.81mm)
6PGHDE	.7510" - .8325"	(17.82mm - 20.37mm)
7PGHDE	.8330" - 1.0150"	(20.38mm - 25.41mm)
8PGHDE	Bundle Deal	Buy all 7 handles



# English Class Z Gage Sets

## Meyer Gage

### Class Z Pin Sets

We started making the original ZZ back in 1965 and our competition has tried, but can't copy the quality of these affordable pin gage sets. We now have taken the extra step for the better pin gage, Class Z.

Introducing the MEYER Z. A closer tolerance (0.0001), more accurate, and better for your needs. (See top right corner of page for details.) We have done it again. We've made a better pin gage that no other has attempted with the same great features listed below.

### FEATURES:

MORE FEATURES THAN GAGES COSTING TWICE THE PRICE.

- All gages and sets are traceable to N.I.S.T.
- Boxes and gages both marked
- Size and serial number laser etched on each piece (M-0 not etched)
- Material: 52100 Bearing Steel
- No sharp edges
- All members 2" long

### USES:

- Checking locations
- Measuring hole sizes and depth
- GO & NOGO gaging
- Setting micrometers
- Checking distances between holes

### Finish:

- Centerless lapped
- Each gage is inspected and has a 8 microfinish or better
- Heat treated to a hardness of 60-62 Rockwell C
- All English gages with 0.0001" limit



Here is a comparison of Class ZZ and the Class Z gage pin specifications.

	OLD Class ZZ	NEW Class Z
Size deviation:	0.0002"	0.0001"
Roundness geometry:	0.0001"	0.00005"
Surface finish:	10 micro	8 micro

The Meyer Gage Class Z gage pin will meet or exceed the requirements of Class ZZ, and can replace the Class ZZ in any situation or application.

Gage Set No.	Gage - Size	Pieces	Wt/Lbs.	*Cal.Report
M0M - minus	0.0110" to 0.0600"	50	1	
M0P - plus	0.0110" to 0.0600"	50	1	
M05M - minus	0.0115" to 0.0605"	50	1	
M05P - plus	0.0115" to 0.0605"	50	1	
C10M - minus	0.0110" to 0.2500"	240	8	
C10P - plus	0.0110" to 0.2500"	240	8	
C105M - minus	0.0115" to 0.2505"	240	8	
C105P - plus	0.0115" to 0.2505"	240	8	
M1M - minus	0.0610" to 0.2500"	190	8	
M1P - plus	0.0610" to 0.2500"	190	8	
M15M - minus	0.0615" to 0.2505"	190	8	
M15P - plus	0.0615" to 0.2505"	190	8	
M2M - minus	0.2510" to 0.5000"	250	23	
M2P - plus	0.2510" to 0.5000"	250	23	
M25M - minus	0.2515" to 0.5005"	250	23	
M25P - plus	0.2515" to 0.5005"	250	23	
M3M - minus	0.5010" to 0.6250"	125	24	
M3P - plus	0.5010" to 0.6250"	125	24	
M35M - minus	0.5015" to 0.6255"	125	24	
M35P - plus	0.5015" to 0.6255"	125	24	
M4M - minus	0.6260" to 0.7500"	125	33	
M4P - plus	0.6260" to 0.7500"	125	33	
M45M - minus	0.6265" to 0.7505"	125	33	
M45P - plus	0.6265" to 0.7505"	125	33	
M5M - minus	0.7510" to 0.8320"	82	29	
M5P - plus	0.7510" to 0.8320"	82	29	
M55M - minus	0.7515" to 0.8325"	82	29	
M55P - plus	0.7515" to 0.8325"	82	29	
M6M - minus	0.8330" to 0.9160"	84	35	
M6P - plus	0.8330" to 0.9160"	84	35	
M65M - minus	0.8335" to 0.9165"	84	35	
M65P - plus	0.8335" to 0.9165"	84	35	
M7M - minus	0.9170" to 1.0000"	84	41	
M7P - plus	0.9170" to 1.0000"	84	41	
M75M - minus	0.9175" to 1.0005"	84	41	
M75P - plus	0.9175" to 1.0005"	84	41	

(\* ) Calibration report for all components is an option, and priced in addition to set price.



# English Class Z Library Sets

Z Model No.	Wt. (lbs)	Size Range	Number of members
LS - minus	87	0.011" to 0.625"	(615 gages)
LS - plus	87	0.011" to 0.625"	(615 gages)
LC - minus	120	0.011" to 0.750"	(740 gages)
LC - plus	120	0.011" to 0.750"	(740 gages)
L1 - minus	120	0.061" to 0.750"	(690 gages)
L1 - plus	120	0.061" to 0.750"	(690 gages)
L2C - minus	96	0.011" to 0.5005"	(980 gages in .0005" increments)
L2C - plus	96	0.011" to 0.5005"	(980 gages in .0005" increments)
L2 - minus	95	0.061" to 0.5005"	(880 gages in .0005" increments)
L2 - plus	95	0.061" to 0.5005"	(880 gages in .0005" increments)
L3 - minus	240	0.061" to 1.000"	(940 gages)
L3 - plus	240	0.061" to 1.000"	(940 gages)
L4 - minus	240	0.011" to 1.000"	(990 gages)
L4 - plus	240	0.011" to 1.000"	(990 gages)
L5 - minus	140	0.751" to 1.000"	(250 gages)
L5 - plus	140	0.751" to 1.000"	(250 gages)

(\*\*) Consists of (2) four - drawer cabinets

(\*) Calibration report for all components is an option, and priced in addition to set price.



# Class ZZ Black OX Gage Sets

Black OX from Meyer Gage  
Gage pins with a durable protective black oxide coating.

*Black OX is a division of Meyer Gage*

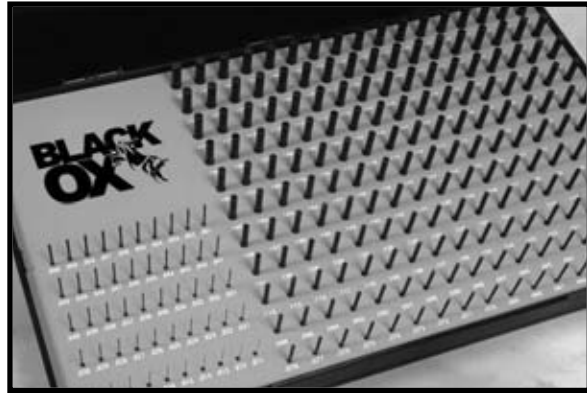

**Features Include:**

- Black Oxide treatment
- Class ZZ 0.061" and larger –gage clearly marked
- No sharp edges
- All gages 2" long
- All pins or sets available in 0.001" increments
- Certificate of conformance to ANSIB89.1.5-1998

**Uses:**

- Measuring hole size and depth-checking locations
- GO & NOGO gaging
- Inspect holes, or slots for pass/fail conditions
- Check micrometers and calipers

**Finish:**

- Black OX surface treatment
- Centerless ground
- 10 micro-inch finish
- Heat treated to 60-62 Rockwell C
- Each gage with 0.0002" limit

P/N	Description
B0M -minus	.011" - .060"
B0P -plus	.011" - .060"
B10M -minus	.011" - .250"
B10P -plus	.011" - .250"
B1M -minus	.061" - .250"
B1P -plus	.061" - .250"
B2M -minus	.251" - .500"
B2P -plus	.251" - .500"
B3M -minus	.501" - .625"
B3P -plus	.501" - .625"
B4M -minus	.626" - .750"
B4P -plus	.626" - .750"



Replacement Pins

Description

- .011" to .060"
- .061" to .500"
- .501" to .625"
- .626" to .750"

IMPORTANT: Specify plus or minus on replacement pins



# Class ZZ Black OX Library Sets

Library Series of Pins with Heavy Duty Tool Chest

P/N	Description
BSM -minus	.011" to .625"
BSP -plus	.011" to .625"
BCM -minus	.011" to .750"
BCP -plus	.011" to .750"
BAM -minus	.061" to .750"
BAP -plus	.061" to .750"

#### Features Include:

- Black Oxide treatment
- Class ZZ 0.061" and larger –gages clearly marked
- No sharp edges
- All gages 2" long
- All pins or sets available in 0.001" increments
- Certificate of conformance to ANSIB89.1.5-1998

#### Uses:

- Measuring hole size and depth-checking locations
- GO & NOGO gaging
- Inspect holes or slots for pass/fail conditions
- Check micrometers and calipers

#### Finish:

- Black OX surface treatment
- Centerless ground
- 10 micro-inch finish
- Heat treated to 60-62 Rockwell C
- Each gage with 0.0002" limit
- Roundness geometry 0.0001" limit



# Metric Z Gage Sets

## Class Z

Just look at this selection of Metric gage pin sets. If we don't make it, you probably don't need it! These sets have all the features of our English sets, but provide the finer increments in size that you just can't get by converting English to Metric.

## Meyer Gage Class Z Pin Sets

### FEATURES:

MORE FEATURES THAN GAGES COSTING TWICE THE PRICE.

- All gages and sets are traceable to N.I.S.T.
- Boxes and gages both marked
- Size and serial number laser etched on each piece (M-0 not etched)
- Material: 52100 Bearing Steel
- No sharp edges
- 51mm overall length
- All sets in .02mm increments

### USES:

- Checking locations
- Measuring hole sizes and depth
- GO & NOGO gaging
- Setting micrometers
- Checking distances between holes

### FINISH:

- Centerless lapped
- Each gage is inspected and has a 8 microfinish or better
- Heat treated to a hardness of 60-62 Rockwell C
- All metric gages with .0025mm tolerance limit



Gage Set No.	Gage - Size	Pieces	Wt/Lbs.
M0MMM - minus	.22 to 1.50	65	1
M0MMP - plus	.22 to 1.50	65	1
M01MMM - minus	.23 to 1.51	65	1
M01MMP - plus	.23 to 1.51	65	1
M1MMM - minus	1.52 to 7.70	310	10
M1MMP - plus	1.52 to 7.70	310	10
M11MMM - minus	1.53 to 7.71	310	10
M11MMP - plus	1.53 to 7.71	310	10
M2MMM - minus	7.72 to 12.70	250	25
M2MMP - plus	7.72 to 12.70	250	25
M21MMM - minus	7.73 to 12.71	250	25
M21MMP - plus	7.73 to 12.71	250	25
M3MMM - minus	12.72 to 15.30	130	24
M3MMP - plus	12.72 to 15.30	130	24
M31MMM - minus	12.73 to 15.31	130	24
M31MMP - plus	12.73 to 15.31	130	24
M4MMM - minus	15.32 to 17.80	125	30
M4MMP - plus	15.32 to 17.80	125	30
M41MMM - minus	15.33 to 17.81	125	30
M41MMP - plus	15.33 to 17.81	125	30
M5MMM - minus	17.82 to 20.36	128	38
M5MMP - plus	17.82 to 20.36	128	38
M51MMM - minus	17.83 to 20.37	128	38
M51MMP - plus	17.83 to 20.37	128	38
M6MMM - minus	20.38 to 22.04	84	32
M6MMP - plus	20.38 to 22.04	84	32
M61MMM - minus	20.39 to 22.05	84	32
M61MMP - plus	20.39 to 22.05	84	32
M7MMM - minus	22.06 to 23.72	84	37
M7MMP - plus	22.06 to 23.72	84	37
M71MMM - minus	22.07 to 23.73	84	37
M71MMP - plus	22.07 to 23.73	84	37
M8MMM - minus	23.74 to 25.40	84	41
M8MMP - plus	23.74 to 25.40	84	41
M81MMM - minus	23.75 to 25.41	84	41
M81MMP - plus	23.75 to 25.41	84	41 (*)

Calibration report for all components is an option, and priced in addition to set price.



# Metric Z Library Sets

## .0025 METRIC LIBRARY SERIES

Model No.	Wt. (lbs)	Size Range	Number of members
L10MM - minus	124	1.52mm to 17.80mm	(815 gages)
L10MM - plus	124	1.52mm to 17.80mm	(815 gages)
L11MM - minus	124	1.53mm to 17.81mm	(815 gages)
L11MM - plus	124	1.53mm to 17.81mm	(815 gages)
L20MM - minus	183	17.82mm to 25.40mm	(380 gages)
L20MM - plus	183	17.82mm to 25.40mm	(380 gages)
L21MM - minus	183	17.83mm to 25.41mm	(380 gages)
L21MM - plus	183	17.83mm to 25.41mm	(380 gages)
**L30MM - minus	305	1.52mm to 25.40mm	(1195 gages)
**L30MM - plus	305	1.52mm to 25.40mm	(1195 gages)
**L31MM - minus	305	1.53mm to 25.41mm	(1195 gages)
**L31MM - plus	305	1.53mm to 25.41mm	(1195 gages)

(\*\*) consists of (2) four-drawer cabinets

(\*) Calibration report for all components is an option, and priced in addition to set price.

**IMPORTANT:** Specify **PLUS** or **MINUS** when ordering individual members.

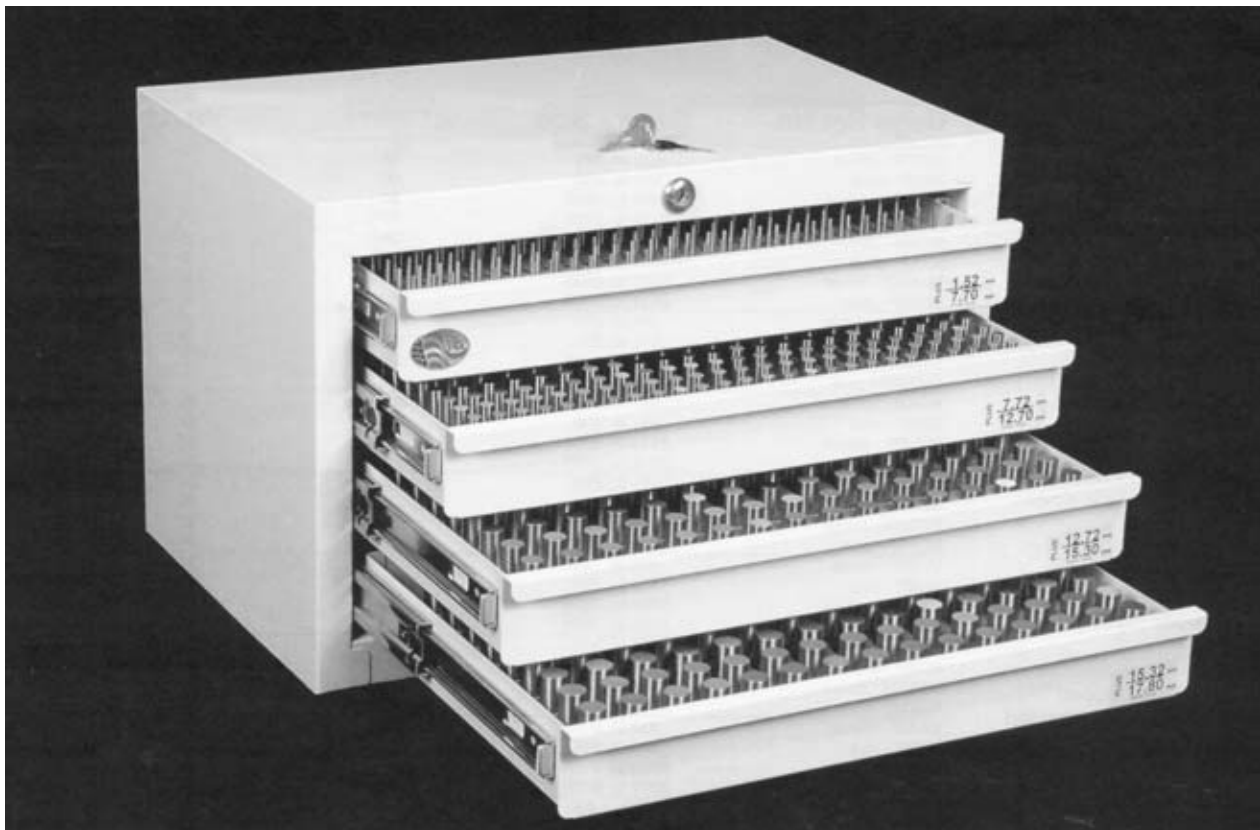

(\*) Calibration report for all components is an option, and priced in addition to set price.





# Class X Gage Sets



Offers the same “features” as our Class Z pin gages, but with 0.00004” tolerance limits and 0.00002” roundness limits. The pins are perfect for critical inspection needs, or when you want to maximize your GO/ NOGO tolerance limits. They’re also a great way to calibrate measuring equipment, micrometers, and calipers.

## FEATURES:

- All gages and sets are traceable to N.I.S.T.
- Boxes and gages both marked
- Size and serial number laser etched on each piece (M0X not etched)
- Material: 52100 Bearing Steel
- No sharp edges
- All members 2” long

## USES:

- Checking locations
- Measuring hole sizes and depth
- GO & NOGO gaging
- Setting micrometers
- Checking distances between holes

## Finish:

- Centerless lapped
- Each gage is inspected and has a 2 microfinish or better
- Heat treated to a hardness of 60-62 Rockwell C
- All English gages with 0.00004” limit

Gage Set No.	Gage - Size	Pieces	Wt/Lbs.
M0XM - minus	.011 to .060	50	1
M0XP - plus	.011 to .060	50	1
M05XM - minus	.0115 to .0605	50	1
M05XP - plus	.0115 to .0605	50	1
M1XM - minus	.061 to .250	190	7
M1XP - plus	.061 to .250	190	7
M15XM - minus	.0615 to .2505	190	7
M15XP - plus	.0615 to .2505	190	7
C10XM - minus	.011 to .250	240	8
C10XP - plus	.011 to .250	240	8
C105XM - minus	.0115 to .2505	240	8
C105XP - plus	.0115 to .2505	240	8
M2XM - minus	.251 to .500	250	23
M2XP - plus	.251 to .500	250	23
M25XM - minus	.2515 to .5005	250	23
M25XP - plus	.2515 to .5005	250	23
M3XM - minus	.501 to .625	125	24
M3XP - plus	.501 to .625	125	24
M35XM - minus	.5015 to .6255	125	24
M35XP - plus	.5015 to .6255	125	24
M4XM - minus	.626 to .750	125	33
M4XP - plus	.626 to .750	125	33
M45XM - minus	.6265 to .7505	125	33
M45XP - plus	.6265 to .7505	125	33
M5XM - minus	.751 to .832	82	29
M5XP - plus	.751 to .832	82	29
M55XM - minus	.7515 to .8325	82	29
M55XP - plus	.7515 to .8325	82	29
M6XM - minus	.833 to .916	84	35
M6XP - plus	.833 to .916	84	35
M65XM - minus	.8335 to .9165	84	35
M65XP - plus	.8335 to .9165	84	35
M7XM - minus	.917 to 1.000	84	41
M7XP - plus	.917 to 1.000	84	41
M75XM - minus	.9175 to 1.0005	84	41
M75XP - plus	.9175 to 1.0005	84	41

(\*) Calibration report for all components is an option, and priced in addition to set price.



# Class X Library Sets

## 0.00004" CLASS X LIBRARY SERIES

Z Model No.	Wt. (lbs)	Size Range	Number of members
LCX - minus	120	.011" to .750"	(740 gages)
LCX - plus	120	.011" to .750"	(740 gages)
L1X - minus	120	.061" to .750"	(690 gages)
L1X - plus	120	.061" to .750"	(690 gages)
L2CX - minus	96	.011" to .5005"	(980 gages in .0005" increments)
L2CX - plus	96	.011" to .5005"	(980 gages in .0005" increments)
L2X - minus	95	.061" to .5005"	(880 gages in .0005" increments)
L2X - plus	95	.061" to .5005"	(880 gages in .0005" increments)
**L3X - minus	240	.061" to 1.000"	(940 gages)
**L3X - plus	240	.061" to 1.000"	(940 gages)
**L4X - minus	240	.011" to 1.000"	(990 gages)
**L4X - plus	240	.011" to 1.000"	(990 gages)

(\*\*)Consists of (2) four-drawer cabinets

(\*) Calibration report for all components in set is an option, and priced in addition to set price.



## Class X MG-25 Series

Used as masters to calibrate measuring equipment and check linearity of comparators, micrometers, and calipers. These "Tenth Step" gage sets have unlimited applications, such as quality control inspection, prototype work and production layout. Inspectors select from the range of pins to find the size of a hole or slot. These round masters simulate a cylindrical part which, unlike flat blocks, can detect uneven wear on the tips of micrometers and calipers. The thin "line" of contact detects uneven face wear better than flat gage blocks with large contact area.

### Features:

- Each set contains 25 pieces of Class X tolerance (.00004") gage pins. Traceable to NIST
- Choice of two tolerances: Plus (+.00004") or Minus (-.00004")
- Sets consist of a center nominal size, and 12 gages larger in .0001" steps and 12 gages smaller in .0001" steps. Metric sets available in 0.01mm increments.
- Each gage is inspected and has a 2 microfinish or better.
- Heat treated and through hardened to 60-62 Rockwell C
- All pin gages over .060" or 1.51 mm are laser marked with size direction of tolerance and serial number for traceability.

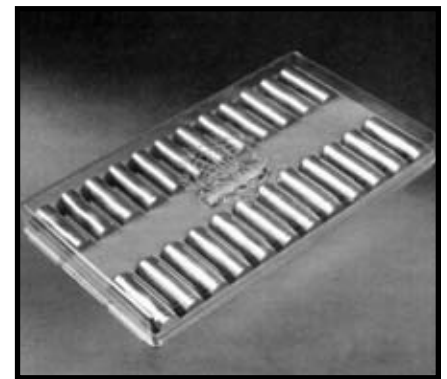

GAGE SET NO.	NOMINAL SIZE RANGE		
	<i>English</i>	<i>or</i>	<i>Metric</i>
MG1-25	.0122" to .0609"		0.28mm to 1.54mm
MG2-25	.0610" to .2509"		1.55mm to 6.37mm
MG3-25	.2510" to .5009"		6.38mm to 12.72mm
MG4-25	.5010" to .7499"		12.73mm to 19.04mm
MG5-25	.7500" to .8129"		19.05mm to 20.64mm

(\*) Calibration report for all components is an option, and priced in addition to set price.



# Custom Length

# Class ZZ Gages

Reversible pin gages up to 12" lengths. These are invaluable when you need to gage deep or hard to reach holes or slots.

- Centerless ground to a 10 microfinish or better
- Made from HSS Steel or E52100
- Plus, Minus or Bilateral tolerance
- NIST Traceable
- Stabilized and heat treated to 60-62RC

Diameter Range	2.5"	3"	4"	5"	6"	9"	12"
0.0110" to 0.0629"	0.279mm to 1.575mm						
0.0630" to 0.1879"	1.576mm to 4.750mm						
0.1880" to 0.2509"	4.751mm to 6.350mm						
0.2510" to 0.3129"	6.351mm to 7.925mm						
0.3130" to 0.3759"	7.926mm to 9.525mm						
0.3760" to 0.4389"	9.526mm to 11.125mm						
0.4390" to 0.5009"	11.126mm to 12.700mm						
0.5010" to 0.5319"	12.701mm to 13.487mm						
0.5320" to 0.5639"	13.488mm to 14.300mm						
0.5640" to 0.5949"	14.301mm to 15.088mm						
0.5950" to 0.6259"	15.089mm to 15.875mm						
0.6260" to 0.6569"	15.876mm to 16.662mm						
0.6570" to 0.6879"	16.663mm to 17.450mm						
0.6880" to 0.7189"	17.451mm to 18.237mm						
0.7190" to 0.7509"	18.238mm to 19.050mm						
0.7510" to 0.7819"	19.051mm to 19.837mm						
0.7820" to 0.8129"	19.838mm to 20.625mm						
0.8130" to 0.8439"	20.626mm to 21.412mm						
0.8440" to 0.8759"	21.413mm to 22.225mm						
0.8760" to 0.9069"	22.226mm to 23.012mm						
0.9070" to 0.9379"	23.013mm to 23.800mm						
0.9380" to 0.9689"	23.801mm to 24.587mm						
0.9690" to 1.0009"	24.588mm to 25.400mm						

No guarantee of straightness due to Centerless Grinding process on these products. Class ZZ custom length gages are not returnable for credit or cancellation.



# Class X Gages

Reversible pin gages in English and Metric up to 6" lengths. Ideal for deep and hard to reach holes or slots.

- Centerless lapped to a 5 microfinish
- Up to 6" long
- NIST Traceable
- Stabilized and heat treated to 60-62 RC
- Plus, Minus or Bilateral tolerance

## Custom Lengths

### OVERALL LENGTH 3" inches

Inch Size	Millimeter Size
.0100" to .0299"	.254mm to .759mm
.0300" to .0599"	.762mm to 1.52mm
.0600" to .2009"	1.52mm to 5.10mm
.2010" to .3749"	5.11mm to 9.52mm
.3750" to .6349"	9.53mm to 16.13mm
.6350" to .7500"	16.13mm to 19.05mm
.7501" to .8750"	19.05mm to 22.23mm
.8751" to 1.000"	22.23mm to 25.40mm

### OVERALL LENGTH 5" inches

Inch Size	Millimeter Size
.0100" to .0299"	.254mm to .759mm
.0300" to .0599"	.762mm to 1.52mm
.0600" to .2009"	1.52mm to 5.10mm
.2010" to .3749"	5.11mm to 9.52mm
.3750" to .6349"	9.53mm to 16.13mm
.6350" to .7500"	16.13mm to 19.05mm
.7501" to .8750"	19.05mm to 22.23mm
.8751" to 1.000"	22.23mm to 25.40mm

### OVERALL LENGTH 4" inches

Inch Size	Millimeter Size
.0100" to .0299"	.254mm to .759mm
.0300" to .0599"	.762mm to 1.52mm
.0600" to .2009"	1.52mm to 5.10mm
.2010" to .3749"	5.11mm to 9.52mm
.3750" to .6349"	9.53mm to 16.13mm
.6350" to .7500"	16.13mm to 19.05mm
.7501" to .8750"	19.05mm to 22.23mm
.8751" to 1.000"	22.23mm to 25.40mm

### OVERALL LENGTH 6" inches

Inch Size	Millimeter Size
.0100" to .0299"	.254mm to .759mm
.0300" to .0599"	.762mm to 1.52mm
.0600" to .2009"	1.52mm to 5.10mm
.2010" to .3749"	5.11mm to 9.52mm
.3750" to .6349"	9.53mm to 16.13mm
.6350" to .7500"	16.13mm to 19.05mm
.7501" to .8750"	19.05mm to 22.23mm
.8751" to .9375"	22.23mm to 23.81mm
.9376" to 1.000"	23.82mm to 25.40mm

No guarantee of straightness, due to Centerless Grinding process on these products. Class X custom length gages are not returnable for credit or cancellation.



# Gage Storage Accessories

## *Durable Poly Cases*

- Poly Case for M-0 Set..... each
- Poly Case for M-1 thru M-8 Set..... each
- Poly Case with insert for M-0 Set ..... each
- Poly Case with insert for M-1 thru M-8 Set ..... each

Each hole size marked on insert.

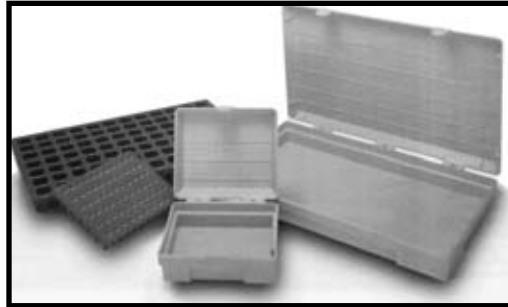

## *Poly Inserts*

- Poly Insert for M-0 Set ..... each
- Poly Insert for M-1 thru M-8 Set ..... each

Each hole size marked on insert.

## *Heavy Duty Metal Storage Cabinets*

Be sure to protect your gages from heat and moisture. After use, each gage should be wiped clean of fingerprints and contaminants, then oiled with a rust inhibitor.



We recommend Tri Flow® lubricant for gage maintenance.

6 oz Aerosol Can



### **Upgrade Existing Sets**

Model Number	Wt./lbs	
L-E4	38	four drawer cabinet, empty
L-IN4	38	four drawer cabinet, w/4 inserts (*)

\* Includes four inserts of your choice. Please specify when ordering.



# Ring Gages\*

## The Meyer Difference

- ❑ **The Material.** We use only superb quality steels such as O6, or Alloy Steels such as 8620, and Heat Treat our blanks to a minimum of 58RC.
- ❑ **The Stabilization Process.** Subsequent grinding operations can introduce heat and stress. All blanks go through a stabilization process, cycling them through temperature extremes from -130°F to +300°F.
- ❑ **The Precision Lapping Process.** “Lapping” is the finishing process that removes small amounts of material from the gage surface and brings it within its final tolerance limits.
- ❑ **Inspection with NIST-traceable gages.** In our Metrology area conditions are a strict, cool 68°F where the relative humidity is between 30 - 50% and all of our masters are traceable to NIST.



### Size Range

Inches Above to & including	Millimeters Above to & including	Class XX			Class X			Class Y, Z		
		Chrome	Steel	Tungsten	Chrome	Steel	Tungsten	Chrome	Steel	Tungsten
.040001 - .100	1.02 - 2.54	—			—			—		
.100001 - .150	2.54 - 3.81	—			—			—		
.150001 - .185	3.81 - 4.70									
.185001 - .230	4.70 - 5.84									
.230001 - .365	5.84 - 9.27									
.365001 - .510	9.27 - 12.95									
.510001 - .825	12.95 - 20.96									
.825001 - 1.135	20.96 - 28.83									
1.135001 - 1.510	28.83 - 38.35									
1.510001 - 2.010	38.35 - 51.05									
2.010001 - 2.510	51.05 - 63.75									
2.510001 - 3.010	63.75 - 76.45									
3.010001 - 3.510	76.45 - 89.15									
3.510001 - 4.010	89.15 - 101.85									

- ❑ MASTER: bilateral (split) tolerance.
- ❑ GO: unilateral (one way) minus tolerance.
- ❑ NOGO: unilateral (one way) plus tolerance.

Ring Gages are manufactured in accordance with ANSI spec B89.1.6 - 1989. ROUNDNESS and TAPER of all gages will not exceed 50% of applicable gagemaker's size tolerance and are non-cumulative. \*Ring gages are not returnable for credit or cancellation.



# Taperlocks\* Steel & Chrome

- Quick change over!
- The members pop out for quick replacement.
- Excellent for larger diameter inspection.
- NIST traceable
- Plus, Minus or Bilateral tolerance
- Class XX, X, Y or Z
- Steel or Chrome



Taperlocks - Steel and Chrome

Unilateral Tolerances • GO = PLUS tolerance, NOGO = MINUS tolerance; Chrome Plates –Add 100%

Size Range	Std. GO Member Only		Std. NOGO Member Only		Handle
	Class	Length	Length	No.	
.1050" to .1500" 2.67mm to 3.81mm	XX				
	X	3/8 "	7/32 "		
	Y	9.5mm	5.6mm	00	
	Z				
.1501" to .2300" 3.81mm to 5.84mm	XX				
	X	13/32 "	9/32 "		
	Y	10.3mm	7.1mm	0	
	Z				
.2301" to .3650" 5.84mm to 9.27mm	XX				
	X	3/4 "	5/16 "		
	Y	19.1mm	7.9mm	1	
	Z				
.3651" to .5100" 9.27mm to 12.95mm	XX				
	X	1 "	3/8 "		
	Y	25.4mm	9.5mm	2	
	Z				
.5101" to .8250" 12.95mm to 20.96mm	XX				
	X	1-1/4 "	1/2 "		
	Y	31.8mm	12.7mm	3	
	Z				
.8251" to 1.1350" 20.96mm to 28.83mm	XX				
	X	1-1/2 "	5/8 "		
	Y	38.1mm	15.9mm	4	
	Z				
1.1351" to 1.5100" 28.83mm to 38.35mm	XX				
	X	1-5/8"	3/4"		
	Y	41.3mm	19.1mm	5	
	Z				

\* Taperlocks are not returnable for credit or cancellation.



# Trilocks\*

## Steel & Chrome



Got really big inspection jobs? These are your best choice for large diameters. Made to order, this is only a partial listing of what we offer. Call us for price and delivery on larger sizes.

### Trilocks - Steel and Chrome

Unilateral Tolerances • GO = PLUS tolerance, NOGO = MINUS tolerance; Chrome Plates –Add 100%

Size Range	Class	Std. GO Member Only	Std. NOGO Member Only		Handle
		Length	Length	No.	
.7601" to .9470" 19.30mm to 24.05mm	XX				
	X	1-1/4 "	3/4 "		
	Y	31.8mm	19.1mm		2-1/2
	Z				
.9471" to 1.1350" 24.05mm to 28.83mm	XX				
	X	1-3/8 "	3/4 "		
	Y	34.9mm	19.1mm		3-1/2
	Z				
1.1351" to 1.5100" 28.83mm to 38.25mm	XX				
	X	1-1/2 "	3/4 "		
	Y	38.1mm	19.1mm		4-1/2
	Z				
1.5101" to 2.0100" 38.25mm to 51.05mm	XX				
	X	1-7/8 "	7/8 "		
	Y	47.6mm	22.2mm		5-1/2
	Z				
2.0101" to 2.5100" 51.05mm to 63.75mm	XX				
	X	2 "	7/8 "		
	Y	50.8mm	22.2mm		6
	Z				
2.5101" to 3.0100" 63.75mm to 76.45mm	XX				
	X	2 "	1 "		
	Y	50.8mm	25.4mm		7
	Z				
3.0101" to 3.5100" 76.45mm to 89.15mm	XX				
	X	2"	1 "		
	Y	50.8mm	25.4mm		7
	Z				

\* Trilocks are not returnable for credit or cancellation.







# Custom Progressive Gages\*

When you need to check parts quickly, Progressive plug gages are the best choice. Both the GO and NOGO diameters are stepped on a single gage member. All members are securely attached to either a Trilock or Taperlock handle. All handles are marked with sizes and direction of tolerance.

- Class XX, X, Y, or Z
- NIST traceable
- GO, NOGO tolerances
- Tool Steel 58/60 Rockwell C
- Certificate of Accuracy included
- Additional marking available per character

**Unilateral Tolerance, GO - Plus Tolerance, NOGO - Minus Tolerance; Chrome Plates: Add 100%**  
 \* -Not returnable for credit or cancellation

		AGD Progressive Member				Handle
Size-Range	Class	Tolerance Inches	Member Length	GO Portion	NOGO Portion	No.
<b>TAPERLOCK STYLE</b>	XX	.00002				\$
.105 in. to .150 in.	X	.00004	23/32 in.	3/8 in.	7/32 in.	00
2.67 mm to 3.81 mm	Y	.00007	18.3 mm	9.5 mm	5.6 mm	
	Z	.00010				
.1501 in. to .230 in.	XX	.00002				
3.81 mm to 5.84 mm	X	.00004	13/16 in.	13/32 in.	9/32 in.	0
	Y	.00007	20.6 mm	10.3 mm	7.1 mm	
	Z	.00010				
.2301 in. to .365 in.	XX	.00002				
5.84 mm to 9.27 mm	X	.00004	13/16 in.	3/4 in.	5/16 in.	1
	Y	.00007	30.2 mm	19.1 mm	7.9 mm	
	Z	.00010				
.3651 in. to .510 in.	XX	.00002				
9.27 mm to 12.95 mm	X	.00004	1-1/2 in.	1 in.	3/8 in.	2
	Y	.00007	38.1 mm	25.4 mm	9.5 mm	
	Z	.00010				
.5101 in. to .825 in.	XX	.00002				
12.95 mm to 20.96 mm	X	.00004	1-7/8 in.	1-1/4 in.	1/2 in.	3
	Y	.00007	47.6 mm	31.8 mm	12.7 mm	
	Z	.00010				
.8251 in. to 1.135 in.	XX	.00003				
20.96 mm to 28.83 mm	X	.00006	2-1/8 in.	1-3/8 in.	5/8 in.	4
	Y	.00009	54.0 mm	34.9 mm	15.9 mm	
	Z	.00012				
1.1351 in. to 1.510 in.	XX	.00003				
28.83 mm to 38.35 mm	X	.00006	2-3/8 in.	1-1/2 in.	3/4 in.	5
	Y	.00009	60.3 mm	38.1 mm	19.1 mm	
	Z	.00012				
<b>TRILOCK STYLE</b>	XX	.00004				
1.5101 in. to 2.010 in.	X	.00008	2-7/8 in.	1-7/8 in.	7/8 in.	5-1/2
38.35 mm to 51.05 mm	Y	.00012	73.0 mm	47.6 mm	22.2 mm	
	Z	.00016				
2.0101 in. to 2.510 in.	XX	.00004				
51.05 mm to 63.75 mm	X	.00008	3 in.	2 in.	7/8 in.	6
	Y	.00012	76.2 mm	50.8 mm	22.2 mm	
	Z	.00016				
2.5101 in. to 3.010 in.	XX	.00005				
63.75 mm to 76.45 mm	X	.00010	3 in.	2 in.	7/8 in.	7
	Y	.00015	76.2 mm	50.8 mm	22.2 mm	
	Z	.00020				
3.0101 in. to 3.510 in.	XX	.00005				
76.45 mm to 89.15 mm	X	.00010	3 in.	2 in.	7/8 in.	7
	Y	.00015	76.2 mm	50.8 mm	22.2 mm	
	Z	.00020				
3.5101 in. to 4.010 in.	XX	.00005				
89.15 mm to 101.85 mm	X	.00010	3-1/8 in.	2-1/8 in.	7/8 in.	7
	Y	.00015	79.4 mm	54.0 mm	22.2 mm	
	Z	.00020				
4.0101 in. to 4.510 in.	XX	.00005				
101.85 mm to 114.55 mm	X	.00010	3-1/8 in.	2-1/8 in.	7/8 in.	7
	Y	.00015	79.4 mm	54.0 mm	22.2 mm	
	Z	.00020				



# Master Setting Discs\*



You can use these Master Discs to calibrate your measuring equipment. They are a must for your calibration lab and your inspection areas. Meyer's Master Discs are available in three styles and come with a Certificate of Accuracy.

- Class XX, X, or Y
- GO, NOGO, Bilateral tolerances available
- Steel 60/62 Rockwell C
- Comes complete with end grips
- Roundness is within half of tolerance

**STYLE #1: Bilateral (Split) tolerance**  
**STYLE #2: Unilateral (GO Plus NOGO Minus)**  
**STYLE #3: Bilateral (Split) tolerance**

\*Note: For the range above 1.510" to and including 8.510" A.G.D. standards for style #2 call for style #3 master discs separated by an A.G.D. separator plate and linked together with a tie rod and insulators. Not returnable for credit or cancellation. Call for sizes not shown.

Size-Range	Class	Tolerance	Style #1		Style #2		Style #3	
			Length	Steel Chrome	Length	Steel Chrome	Length	Steel Chrome
	XX	.00002						\$
.1500 in. to .2300 in.	X	.00004	7/8 in.		7/8 in.		7/16 in.	
3.81 mm to 5.84 mm	Y	.00007	22.2 mm		22.2 mm		11.1 mm	
	XX	.00002						
.2301 in. to .365 in.	X	.00004	1 in.		1 in.		1/2 in.	
5.84 mm to 9.27 mm	Y	.00007	25.4 mm		25.4 mm		12.7 mm	
	XX	.00002						
.3651 in. to .510 in.	X	.00004	1 1/8 in.		1 1/8 in.		9/16 in.	
9.27 mm to 12.95 mm	Y	.00007	28.6 mm		28.6 mm		14.3 mm	
	XX	.00002						
.5101 in. to .825 in.	X	.00004	1 1/4 in.		1 1/4 in.		5/8 in.	
12.95 mm to 20.96 mm	Y	.00007	31.8 mm		31.8 mm		15.9 mm	
	XX	.00003						
.8251 in. to 1.135 in.	X	.00006	1 3/8 in.		1 3/8 in.		11/16 in.	
20.96 mm to 28.83 mm	Y	.00009	34.9 mm		34.9 mm		17.5 mm	
	XX	.00003						
1.1351 in. to 1.510 in.	X	.00006	1 5/8 in.		1 5/8 in.		13/16 in.	
28.83 mm to 38.35 mm	Y	.00009	41.3 mm		41.3 mm		20.6 mm	
	XX	.00004						
1.5101 in. to 2.010 in.	X	.00008	1 7/8 in.		2 in.		7/8 in.	
38.35 mm to 51.05 mm	Y	.00012	47.6 mm		50.8 mm		22.2 mm	
	XX	.00004						
2.0101 in. to 2.510 in.	X	.00008	2 in.		2 in.		7/8 in.	
51.05 mm to 63.75 mm	Y	.00012	50.8 mm		50.8 mm		22.2 mm	
	XX	.00005						
2.5101 in. to 3.010 in.	X	.00010	2 in.		2 1/4 in.		1 in.	
63.75 mm to 76.45 mm	Y	.00015	50.8 mm		57.2 mm		25.4 mm	
	XX	.00005						
3.0101 in. to 3.510 in.	X	.00010	2 in.		2 1/4 in.		1 in.	
76.45 mm to 89.15 mm	Y	.00015	50.8 mm		57.2 mm		25.4 mm	
	XX	.00005						
3.5101 in. to 4.010 in.	X	.00010	2 1/8 in.		2 1/4 in.		1 in.	
89.15 mm to 101.85 mm	Y	.00015	54.0 mm		57.2 mm		25.4 mm	
	XX	.00005						
4.0101 in. to 4.510 in.	X	.00010	2 1/8 in.		2 1/4 in.		1 in.	
101.85 mm to 114.55 mm	Y	.00015	54.0 mm		57.2 mm		25.4 mm	
	XX	.000065						
4.5101 in. to 5.010 in.	X	.00013	2 in.		2 1/4 in.		1 in.	
114.55 mm to 127.25 mm	Y	.00019	54.0 mm		57.2 mm		25.4 mm	
	XX	.000065						
5.0101 in. to 5.510 in.	X	.00013	2 1/8 in.		2 1/4 in.		1 in.	
127.25 mm to 139.95 mm	Y	.00019	54.0 mm		57.2 mm		25.4 mm	
	XX	.000065						
5.5101 in. to 6.010 in.	X	.00013	2 1/8 in.		2 1/4 in.		1 in.	
139.95 mm to 152.65 mm	Y	.00019	54.0 mm		57.2 mm		25.4 mm	



# 60° Thread Measuring Wires



## 60° Threads

(G)				(G)			
(n) Threads per Inch	Nominal Best Wire Diameter	(C) Nominal Constant	(Set of Three)	(n) Threads per Inch	Nominal Best Wire Diameter	(C) Nominal Constant	(Set of Three)
120	0.00481	0.00722		16	0.03608	0.05413	
100	0.00577	0.00866		14	0.04124	0.06186	
96	0.00601	0.00902		13	0.04441	0.06662	
90	0.00642	0.00962		12	0.04811	0.07217	
80	0.00722	0.01083		11 1/2	0.05020	0.07531	
72	0.00802	0.01203		11	0.05249	0.07873	
64	0.00902	0.01353		10	0.05774	0.08660	
56	0.01031	0.01546		9	0.06415	0.09623	
50	0.01155	0.01732		8	0.07217	0.10825	
48	0.01203	0.01804		7 1/2	0.07698	0.11547	
44	0.01312	0.01968		7	0.08248	0.12372	
40	0.01443	0.02165		6	0.09623	0.14434	
36	0.01604	0.02406		5 1/2	0.10497	0.15746	
32	0.01804	0.02706		5	0.11547	0.17321	
30	0.01925	0.02887		4 1/2	0.12830	0.19245	
28	0.02062	0.03093		4	0.14434	0.21651	
27	0.02138	0.03208		3	0.16496	0.24744	
26	0.02221	0.03331		3 1/2	0.17765	0.26647	
24	0.02406	0.03608		3 1/4	0.19245	0.28868	
22	0.02624	0.03936		2 3/4	0.20995	0.31492	
20	0.02887	0.04330		2 1/2	0.23094	0.34641	
18	0.03208	0.04811		2	0.28868	0.43301	

## 60° Metric Threads

Pitch mm	Nominal Best Wire Diameter mm	Nominal Constant mm	(Set of Three)
.2	0.1155	0.1732	
.225	0.1299	0.1949	
.25	0.1443	0.2165	
.3	0.1732	0.2598	
.35	0.2021	0.3031	
.4	0.2309	0.3464	
.45	0.2598	0.3897	
.5	0.2887	0.4330	
.6	0.3464	0.5196	
.7	0.4041	0.6062	
.75	0.4330	0.6495	
.8	0.4619	0.6928	
.9	0.5196	0.7794	
1.0	0.5774	0.8660	
1.25	0.7217	1.0825	
1.5	0.8660	1.2990	
1.75	1.0104	1.5155	
2.0	1.1547	1.7321	
2.5	1.4434	2.1651	
3.0	1.7321	2.5981	
3.5	2.0207	3.0311	
4.0	2.3094	3.4641	
4.5	2.5981	3.8971	
5.0	2.8868	4.3301	
5.5	3.1754	4.7631	
6.0	3.4641	5.1962	
7.0	4.0415	6.0622	
8.0	4.6188	6.9282	
9.0	5.1962	7.7942	
10.0	5.7735	8.6603	

## 29° Acme Best Threads

(n) Threads per Inch	(G) Nominal Best Wire Diameter	(Set of Three)
1	0.51645	
11/3	0.38734	
11/2	0.34430	
13/4	0.29511	
2	0.25823	
2 1/2	0.20658	
3	0.17215	
3 1/2	0.14756	
4	0.12911	
4 1/2	0.11477	
5	0.10329	
5 1/2	0.09390	
6	0.08608	
7	0.07378	
8	0.06456	
9	0.05738	
10	0.05164	
12	0.04304	
14	0.03689	
16	0.03228	
18	0.02869	
20	0.02582	

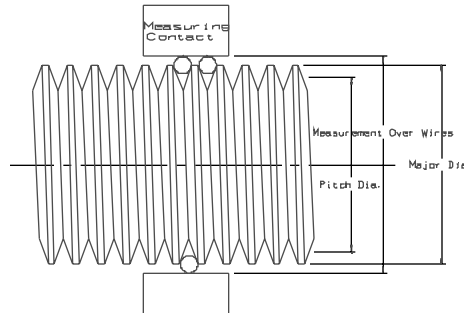

Meyer Gage Thread Measuring Wires, are manufactured as a matched set of three wires per ASME B89.1.17. Each wire diameter is matched to the others within  $\pm 0.00001$ ". The diameters of the three wires shall be within  $\pm 0.00002$ " of the calculated best wire diameter.

- 100% inspection
- 2 microfinish or better
- Tool Steel
- All members 2" long
- Meets former federal Specification GGG-W-366b for Grade A Master Thread Wires

## Thread Measuring Wire Sets

### 60° Thread Measuring Wires

Set No. 30 HS\*  
30 Sizes (5 to 80 TPI) with wood case

Set No. 34 HS  
34 Sizes (4 to 80 TPI) with wood case

Set No. 20 HS\*  
20 Sizes (6 to 36 TPI) with wood case

### 60° Metric Thread Measuring Wires

Set No. 30M  
30 Sizes (.2 pitch to 10 pitch) with wood case

Set No. 23M  
23 Sizes (.3 pitch to 6 pitch) with wood case

\* 7-1/2 & 22 TPI not included in these sets.

\*\* Not all sizes available



## GEAR MEASURING WIRES

- All Gear Measuring Wires meet or exceed former Fed. Spec. GGG-W-366b for Grade AM.G.W
- For three wire sets, add 50%

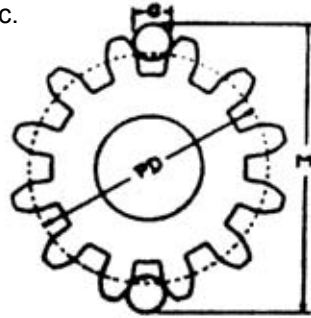

- Wires are lapped to 2 RMS micro inch finish or less and measure to exacting specifications.

### GRADE A MASTER GEAR WIRES

### Product Group #17-00

P	Wire Diameter for Enlarged Pinions 1.92"		Wire Diameter for External Gears 1.728"		Alternate Series 1.68"		Wire Diameter for Internal Gears 1.44"		(set of Two Wires)
	P	Item No.	P	Item No.	P	Item No.	P	Item No.	
2	0.96000	M706030	0.86400	M703030	0.84000	M704030	0.72000	M707030	
2-1/2	0.76800	M706029	0.69120	M703029	0.67200	M704029	0.57600	M707029	
3	0.64000	M706028	0.57600	M703028	0.56000	M704028	0.48000	M707028	
4	0.48000	M706027	0.43200	M703027	0.42000	M704027	0.36000	M707027	
5	0.38400	M706026	0.34560	M703026	0.33600	M704026	0.28800	M707026	
6	0.32000	M706025	0.28800	M703025	0.28000	M704025	0.24000	M707025	
7	0.27428	M706024	0.24686	M703024	0.24000	M704024	0.20571	M707024	
8	0.24000	M706023	0.21600	M703023	0.21000	M704023	0.18000	M707023	
9	0.21333	M706022	0.19200	M703022	0.18666	M704022	0.16000	M707022	
10	0.19210	M706021	0.17280	M703021	0.16800	M704021	0.14400	M707021	
11	0.17454	M706020	0.15709	M703020	0.15273	M704020	0.13091	M707020	
12	0.16000	M706019	0.14400	M703019	0.14000	M704019	0.12000	M707019	
14	0.13714	M706018	0.12343	M703018	0.12000	M704018	0.10286	M707018	
16	0.12000	M706017	0.10800	M703017	0.10500	M704017	0.09000	M707017	
18	0.10667	M706016	0.09600	M703016	0.09333	M704016	0.08000	M707016	
20	0.09600	M706015	0.08640	M703015	0.08400	M704015	0.07200	M707015	
22	0.08727	M706014	0.07855	M703014	0.07636	M704014	0.06545	M707014	
24	0.08000	M706013	0.07200	M703013	0.07000	M704013	0.06000	M707013	
28	0.06857	M706012	0.06171	M703012	0.06000	M704012	0.05143	M707012	
32	0.06000	M706011	0.05400	M703011	0.05250	M704011	0.04500	M707011	
36	0.05333	M706010	0.04800	M703010	0.04667	M704010	0.04000	M707010	
40	0.04800	M706009	0.04320	M703009	0.04200	M704009	0.03600	M707009	
48	0.04000	M706008	0.03600	M703008	0.03500	M704008	0.03000	M707008	
64	0.03000	M706007	0.02700	M703007	0.02625	M704007	0.02250	M707007	
72	0.02667	M706006	0.02400	M703006	0.02333	M704006	0.02000	M707006	
80	0.02400	M706005	0.02160	M703005	0.02100	M704005	0.01800	M707005	
96	0.02000	M706004	0.01800	M703004	0.01750	M704004	0.01500	M707004	
100	0.01920	M706003	0.01728	M703003	0.01680	M704003	0.01440	M707003	
120	0.01600	M706002	0.01440	M703002	0.01400	M704002	0.01200	M707002	
128	0.01500	M706001	0.01350	M703001	0.01312	M704001	0.01125	M707001	
200	0.00960	M706000	0.00864	M703000	0.00840	M704000	0.00720	M707000	



## 3-WIRE THREAD MEASURING SYSTEM

**Wire Holders** - The wire holders are fitted on anvils of the micrometer allowing the single and double measuring wires to accurately position in relation to each other. The extra length of the wire enables them to be adjusted up or down in the holders. This extends the life of the wires substantially. The holders are limited to their rotational movement by the "U" Track and thus are maintained in the ideal position for engaging any lead angle of a thread.

**Measuring Wires** - The measuring wires are certified to meet the following specifications:

Meyer Gage Thread Measuring Wires, are manufactured as a matched set of three wires per ASM B89.1.17. Each wire diameter is matched to the others within  $\pm 0.00001"$ . The diameters of the three wires shall be within  $0.00002"$  of the calculated best wire diameter.



All measuring wires come with a certificate, which includes the actual wire size and the constant required in determining the pitch diameter.

### 60 DEGREE THREAD 3-WIRE SETS WITH HOLDERS Product Group #16-20H

Threads Per Inch	Nominal Diameter	Holder Only			Holders w/Wires	
		.250" Anvil	.300" Anvil	Item Nos. .375" Anvil	Item No.	Set
80	0.00722	M910325	M910326	M910327	M730800	
72	0.00802	M910319	M910320	M910321	M730720	
64	0.00902	M910313	M910314	M910315	M730640	
56	0.01031	M910306	M910307	M910308	M730560	
50	0.01155	M910303	M910304	M910305	M730500	
48	0.01203	M910296	M910297	M910298	M730480	
44	0.01312	M910293	M910294	M910295	M730440	
40	0.01443	M910290	M910291	M910292	M730400	
36	0.01604	M910283	M910284	M910285	M730360	
32	0.01804	M910280	M910281	M910282	M730320	
30	0.01925	M910277	M910278	M910279	M730300	
28	0.02062	M910268	M910269	M910270	M730280	
27	0.02138	M910265	M910266	M910267	M730270	
26	0.02221	M910262	M910263	M910264	M730260	
24	0.02406	M910259	M910260	M910261	M730240	
22	0.02624	M910256	M910257	M910258	M730220	
20	0.02887	M910253	M910254	M910255	M730200	
18	0.03208	M910244	M910245	M910246	M730180	
16	0.03608	M910241	M910242	M910243	M730160	
14	0.04124	M910238	M910239	M910240	M730140	
13	0.04441	M910235	M910236	M910237	M730130	
12	0.04811	M910232	M910233	M910234	M730120	
11-1/2	0.05020	M910226	M910227	M910228	M730115	
11	0.05249	M910229	M910230	M910231	M730110	
10	0.05774	M910223	M910224	M910225	M730100	
9	0.06415	M910331	M910332	M910333	M730090	
8	0.07217	M910328	M910329	M910330	M730080	
7	0.08248	M910322	M910323	M910324	M730070	
6	0.09623	M910316	M910317	M910318	M730060	
5	0.11547	M910309	M910310	M910311	M730050	

When ordering, please specify "Threads Per Inch" and Anvil Size.



## 3-WIRE THREAD MEASURING SYSTEM

### 60 DEGREE METRIC THREAD WIRE SETS WITH HOLDERS Product Group #16-20H

Pitch mm	Best mm	Wire Size Inch Equiv.	Holder Only Item No.			Holders w/Wires Item Set
			.250" Anvil	.300" Anvil	.375" Anvil	
.35mm	0.2021	0.00796	M910175	M910176	M910177	M740350
.40mm	0.2309	0.00909	M910184	M910185	M910186	M740400
.45mm	0.2598	0.01023	M910181	M910182	M910183	M740450
.50mm	0.2887	0.01137	M910190	M910191	M910192	M740500
.55mm	0.3175	0.01250	M910187	M910188	M910189	M740550
.60mm	0.3464	0.01364	M910193	M910194	M910195	M740600
.70mm	0.4041	0.01591	M910199	M910200	M910201	M740700
.75mm	0.4330	0.01705	M910196	M910197	M910198	M740750
.80mm	0.4619	0.01819	M910205	M910206	M910207	M740800
.85mm	0.4907	0.01932	M910202	M910203	M910204	M740850
.90mm	0.5196	0.02046	M910208	M910209	M910210	M740900
1.00mm	0.5774	0.02273	M910211	M910212	M910213	M741000
1.25mm	0.7217	0.02841	M910214	M910215	M910216	M741250
1.50mm	0.8660	0.03409	M910217	M910218	M910219	M741500
1.75mm	1.0104	0.03978	M910220	M910221	M910222	M741750
2.00mm	1.1547	0.04546	M910247	M910248	M910249	M742000
2.50mm	1.4434	0.05683	M910250	M910251	M910252	M742500
3.00mm	1.7321	0.06819	M910271	M910272	M910273	M743000
3.50mm	2.0270	0.07980	M910274	M910275	M910276	M743500
4.00mm	2.3094	0.09092	M910286	M910287	M910288	M744000

When ordering, specify Pitch" and Anvil Size.  
Individual Holders available, price on application.

### THREAD MEASURING WIRE SETS Product Group #16-00S

	Wooden Case With Wires Only	Wooden Case w/Wires and Holders
	Item No.	Item No.
<b>60 Degree Thread Measuring Wires</b>		
Set No. 30 HS*		
30 Sizes (5 to 80 TPI), with case	M396890	M396895
Set No. 34 HS		
34 Sizes (4 to 80 TPI), with case	M396920	M396925
Set No. 20 HS*		
20 Sizes (6 to 36 TPI), with case	M396880	M396980
Set No. 20 TC		
20 Sizes (6 to 36 TPI), with case	M396990	M396995
	Price on Request	Price on Request
<b>60 Degree Metric Thread Measuring Wires</b>		
Set No. 30 M		
30 Sizes (.2 to 10 pitch), with case	M396910	M396915
Set No. 23 HS		
23 Sizes (.3 to 6 pitch), with case	M396900	M396905
<b>29 Degree Acme Best Thread</b>		
Set No. 22 AB		
22 Sizes (1 to 20 TPI), with case	M397000	N/A**
Set No. 16 AB		
16 Sizes (3-1/2 to 20 TPI), with case	—	M397005



\*7-1/2 & 22 TPI not included in these sets.  
\*\*Not all sizes available.  
Case and vials are available, price on request.



# Taperlock Steel Thread Plug Gages

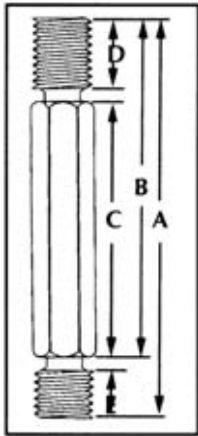

Thread plug gages are made of selected steel, manufactured with the finest equipment available, and meticulously inspected in every thread element. The name Meyer Gage is your guarantee of the finest in thread gages.

Standard in "X" tolerance.

Optional color gage handles available upon request — ideal to identify metric versus inch or master versus working gages.

The shanks on the gaging members are tapered to fit corresponding taper holes in the handles. Worn members may be removed and the handles salvaged for use with new members.

Member sizes 0 - 6 have male point in addition to length shown. Chip grooves are supplied on GO Members #10 machine screw and larger.

Nominal Size		A Overall	B GO Member & Handle	Length C Handle Only	D GO Member	E NOGO Member	Handle	
Inch	mm						Hex Size	No.
0, 1, 2, 3	1.6, 2, 2.5	2-1/2	2-1/32	1-1/2	1/4	3/16	3/16	000
4, 5, 6	3, 3.5	2-31/32	2-13/32	1-3/4	5/16	7/32	1/4	00
8, 10, 12	4, 4.5, 5	3-3/16	2-21/32	2	13/32	9/32	5/16	0
1/4, 5/16	6, 6.3, 7, 8	4-1/16	3-1/2	2-3/4	1/2	5/16	3/8	1
3/8, 7/16, 1/2	10, 12	4-5/8	4	3	3/4	3/8	1/2	2
9/16, 5/8, 3/4	14, 16, 18, 20	5-1/8	4-3/8	3-1/4	7/8	1/2	11/16	3
7/8, 1, 1-1/8	24	5-7/8	4-15/16	3-5/8	1	5/8	7/8	4
1-1/4, 1-3/8, 1-1/2		5-1/2 + D	4-3/8 + D	4	*	3/4	1	5

\*D=1" for 12 threads per inch and finer; 1-1/4" for threads per inch coarser than 12. Item numbers and prices on next page.

## CLASS X THREAD GAGE TOLERANCES

Thread per Inch	Tolerance Lead, Inch	Tolerance on Half Angle of Thread °± min.	Major or Minor Diameter		To and Including 1-1/2" Diameter	Tolerance on Pitch Diameter		Above 8" to 12" Diameter
			To and Including 4" Diameter	Above 4" Diameter		Above 1-1/2" to 4" Diameter	Above 4" to 8" Diameter	
80	.0002	0° 30'	.0003	—	.0002	—	—	—
72	.0002	0° 30'	.0003	—	.0002	—	—	—
64	.0002	0° 30'	.0004	—	.0002	—	—	—
56	.0002	0° 30'	.0004	—	.0002	.0003	—	—
48	.0002	0° 30'	.0004	—	.0002	.0003	—	—
40	.0002	0° 20'	.0004	—	.0002	.0003	—	—
36	.0002	0° 20'	.0004	—	.0002	.0003	—	—
32	.0003	0° 15'	.0005	.0007	.0003	.0004	.0005	.0006
28	.0003	0° 15'	.0005	.0007	.0003	.0004	.0005	.0006
27	.0003	0° 15'	.0005	.0007	.0003	.0004	.0005	.0006
24	.0003	0° 15'	.0005	.0007	.0003	.0004	.0005	.0006
20	.0003	0° 15'	.0005	.0007	.0003	.0004	.0005	.0006
18	.0003	0° 10'	.0005	.0007	.0003	.0004	.0005	.0006
16	.0003	0° 10'	.0006	.0009	.0003	.0004	.0006	.0008
14	.0003	0° 10'	.0006	.0009	.0003	.0004	.0006	.0008
13	.0003	0° 10'	.0006	.0009	.0003	.0004	.0006	.0008
12	.0003	0° 10'	.0006	.0009	.0003	.0004	.0006	.0008
11-1/2	.0003	0° 10'	.0006	.0009	.0003	.0004	.0006	.0008
11	.0003	0° 10'	.0006	.0009	.0003	.0004	.0006	.0008
10	.0003	0° 10'	.0006	.0009	.0003	.0004	.0006	.0008
9	.0003	0° 10'	.0007	.0011	.0003	.0004	.0006	.0008
8	.0004	0° 5'	.0007	.0011	.0004	.0005	.0006	.0008
7	.0004	0° 5'	.0007	.0011	.0004	.0005	.0006	.0008
6	.0004	0° 5'	.0008	.0013	.0004	.0005	.0006	.0008
5	.0004	0° 5'	.0008	.0013	—	.0005	.0006	.0008
4-1/2	.0004	0° 5'	.0008	.0013	—	.0005	.0006	.0008
4	.0004	0° 5'	.0009	.0015	—	.0005	.0006	.0008



# Taperlock Steel Thread Plug Gages

- Machined from the highest quality oil hardened tool steels
- Manufactured on the latest equipment under ideal conditions
- Meticulously inspected in every thread element
- Chip grooves are supplied on all GO members #10 Machine Screw and larger
- Standard in "X" tolerance, standard A.G.D. dimensions
- Special thread plug gages available expedited delivery



## HOW TO ORDER

1. Quantity and type (member only, member with handle or double end with handle).
2. Specify nominal size and threads per inch, GO and/or NOGO.
3. Class of fit: 2B or 3B.
4. Handles are not included with single members.
5. If handle is required with a single member, please specify "with handle" at time of order.
6. Include special marking instructions if any.
7. For Taperlock members with Chrome add 100%.
8. Special Thread Plug Gages price on application.
9. If Special Pitch diameter limits specify GO and NOGO gages.

## TAPERLOCK STYLE WORK PLUG GAGES

## Product Group #19-00T

	Nominal Size		GO Member		NOGO Member		Double End w/Handle		Handle Only Size
			Class 2B or 3B Item No.	Class 2B Item No.	Class 3B Item No.	Per Member	Class 2B Item No.	Class 3B Item No.	
0	80	UNF	M150100	M160100	M170100		M150116	M150117	000
1	64	UNC	M150200	M160200	M170200		M150216	M150217	000
1	72	UNF	M150300	M160300	M170300		M150316	M150317	000
2	56	UNC	M150400	M160400	M170400		M150416	M150417	000
2	64	UNF	M150500	M160500	M170500		M150516	M150517	000
3	48	UNC	M150600	M160600	M170600		M150616	M150617	000
3	56	UNF	M150700	M160700	M170700		M150716	M150717	000
4	40	UNC	M150900	M160900	M170900		M150916	M150917	00
4	48	UNF	M151000	M161000	M171000		M151016	M151017	00
5	40	UNC	M151100	M161100	M171100		M151116	M151117	00
5	44	UNF	M151200	M161200	M171200		M151216	M151217	00
6	32	UNC	M151300	M161300	M171300		M151316	M151317	0
6	40	UNF	M151400	M161400	M171400		M151416	M151417	0
8	32	UNC	M151500	M161500	M171500		M151516	M151517	0
8	36	UNF	M151600	M161600	M171600		M151616	M151617	0
10	24	UNC	M151700	M161700	M171700		M151716	M151717	0
10	32	UNF	M151800	M161800	M171800		M151816	M151817	0
12	24	UNC	M151900	M161900	M171900		M151916	M151917	0
12	28	UNF	M152000	M162000	M172000		M152016	M152017	0
12	32	UNEF	M152100	M162100	M172100		M152116	M152117	0
1/4	20	UNC	M152200	M162200	M172200		M152216	M152217	1
1/4	28	UNF	M152300	M162300	M172300		M152316	M152317	1
1/4	32	UNEF	M152400	M162400	M172400		M152416	M152417	1
5/16	18	UNC	M152500	M162500	M172500		M152516	M152517	1
5/16	24	UNF	M152600	M162600	M172600		M152616	M152617	1
5/16	32	UNEF	M152700	M162700	M172700		M152716	M152717	1
3/8	16	UNC	M152800	M162800	M172800		M152816	M152817	2
3/8	24	UNF	M152900	M162900	M172900		M152916	M152917	2
3/8	32	UNEF	M153000	M163000	M173000		M153016	M153017	2
7/16	14	UNC	M153100	M163100	M173100		M153116	M153117	2
7/16	20	UNF	M153200	M163200	M173200		M153216	M153217	2
7/16	28	UNEF	M153300	M163300	M173300		M153316	M153317	2
1/2	13	UNC	M153400	M163400	M173400		M153416	M153417	2

continued on next page





Nominal Size			GO Member Class 2B or 3B Item No.	NOGO Member		Per Member	Double End w/Handle		Handle Only Size
			Class 2B Item No.	Class 3B Item No.	Class 2B Item No.		Class 3B Item No.		
1/2	20	UNF	M153500	M163500	M173500		M153516	M153517	2
1/2	28	UNEF	M153600	M163600	M173600		M153616	M153617	2
9/16	12	UNC	M153700	M163700	M173700		M153716	M153717	3
9/16	18	UNF	M153800	M163800	M173800		M153816	M153817	3
9/16	24	UNEF	M153900	M163900	M173900		M153916	M153917	3
5/8	11	UNC	M154000	M164000	M174000		M154016	M154017	3
5/8	18	UNF	M154100	M164100	M174100		M154116	M154117	3
5/8	24	UNEF	M154200	M164200	M174200		M154216	M154217	3
11/16	24	UNEF	M154300	M164300	M174300		M154316	M154317	3
3/4	10	UNC	M154400	M164400	M174400		M154416	M154417	3
3/4	16	UNF	M154500	M164500	M174500		M154516	M154517	3
3/4	20	UNEF	M154600	M164600	M174600		M154616	M154617	3
13/16	20	UNEF	M154700	M164700	M174700		M154716	M154717	3
7/8	9	UNC	M154800	M164800	M174800		M154816	M154817	4
7/8	14	UNF	M154900	M164900	M174900		M154916	M154917	4
7/8	20	UNEF	M155000	M165000	M175000		M155016	M155017	4
15/16	20	UNEF	M155100	M165100	M175100		M155116	M155117	4
1	8	UNC	M155200	M165200	M175200		M155216	M155217	4
1	12	UNF	M155300	M165300	M175300		M155316	M155317	4
1	14	UNS	M155400	M165400	M175400		M155416	M155417	4
1	20	UNEF	M155500	M165500	M175500		M155516	M155517	4
1-1/16	18	UNEF	M155600	M165600	M175600		M155616	M155617	4
1-1/8	7	UNC	M155700	M165700	M175700		M155716	M155717	4
1-1/8	12	UNF	M155800	M165800	M175800		M155816	M155817	4
1-1/8	18	UNEF	M155900	M165900	M175900		M155916	M155917	4
1-3/16	18	UNEF	M156000	M166000	M176000		M156016	M156017	5
1-1/4	7	UNC	M156100	M166100	M176100		M156116	M156117	5
1-1/4	12	UNF	M156200	M166200	M176200		M156216	M156217	5
1-1/4	18	UNEF	M156300	M166300	M176300		M156316	M156317	5
1-5/16	18	UNEF	M156400	M166400	M176400		M156416	M156417	5
1-3/8	6	UNC	M156500	M166500	M176500		M156516	M156517	5
1-3/8	12	UNF	M156600	M166600	M176600		M156616	M156617	5
1-3/8	18	UNEF	M156700	M166700	M176700		M156716	M156717	5
1-7/16	18	UNEF	M156800	M166800	M176800		M156816	M156817	5
1-1/2	6	UNC	M156900	M166900	M176900		M156916	M156917	5
1-1/2	12	UNF	M157000	M167000	M177000		M157016	M157017	5
1-1/2	18	UNEF	M157100	M167100	M177100		M157116	M157117	5



# TRILOCK REVERSIBLE STEEL THREAD PLUG GAGES

- Trilock gages are reversible, doubling gage wear life.
- When worn out at one end, they may be reversed on the specially designed handle and the unused end can be put to use.
- Available as Class 2B.
- Gage member is held on the handle by means of a socket head cap screw.
- For chrome, add 100%.
- For class 3B, price on application.
- Standard in Class X tolerance.

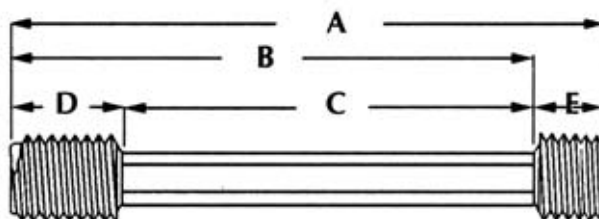

• General Dimensions

Nominal Size	A Overall	B GO Member & Handle	Length C Handle Only	D GO Member	E NOGO Member	Handle	
						Handle Hex Size	No.
7/8	5-3/4	5	4	1	3/4	1/2	2-1/2
1	5-7/8	5-1/8	4	1-1/8	3/4	5/8	3-1/2
1-1/8-7	6-1/8	5-3/8	4	1-3/8	3/4	5/8	3-1/2
1-1/8-12	5-7/8	5-1/8	4	1-1/8	3/4	5/8	3-1/2
1-1/4-7	5-7/8	5-1/2	4	1-1/8	3/4	13/16	4-1/2
1-1/4-12	6	5-1/4	4	1-1/4	3/4	13/16	4-1/2
1-3/8-6, 1-1/2-6	6-1/4	5-1/2	4	1-1/2	3/4	13/16	4-1/2
1-3/8-12, 1-1/2-12	6	5-1/4	4	1-1/4	3/4	13/16	4-1/2

## TRILOCK REVERSIBLE STYLE

*Product Group #19-00TRI*

Nominal Size			GO Member Class 2B or 3B Item No.	NOGO Member Class 2B Item No.	Double End w/Handle Class 2B Item No.	Handle Only No.
7/8	9	UN	M104800	M114800	M104811	2-1/2
7/8	14	UN	M104900	M114900	M104911	2-1/2
1	8	UN	M105200	M115200	M105211	3-1/2
1	12	UN	M105300	M115300	M105311	3-1/2
1-1/8	7	UN	M105700	M115700	M105711	3-1/2
1-1/8	12	UN	M105800	M115800	M105811	3-1/2
1-1/4	7	UN	M106100	M116100	M106111	4-1/2
1-1/4	12	UN	M106200	M116200	M106211	4-1/2
1-3/8	6	UN	M106500	M116500	M106511	4-1/2
1-3/8	12	UN	M106600	M116600	M106611	4-1/2
1-1/2	6	UN	M106900	M116900	M106911	4-1/2
1-1/2	12	UN	M107000	M117000	M107011	4-1/2

Handles are not included with single members. If handles are required for GO or NOGO members, specify "with handle".

3B Gages are available and priced the same as 2B Gages.

When ordering, please use items numbers.



## HELICAL COIL TAPERLOCK STEEL GAGES (STI)

- Standard in Class X Tolerance.
- Handles are not included with single members.
- If handles are required for GO or NOGO members, specify "with handle".
- For "W" Tolerance add 33.3%.
- Titanium Nitride coated members available, price on application.
- Larger sizes available, price on application.
- Metric sizes available, price on application.

### HOW TO ORDER

1. Specify quantity and type (members only, member with handle or double end with handle).
2. Specify nominal diameter and threads per inch GO and/or NOGO.
3. Select class of fit, 2B or 3B.
4. Special marking instructions, if any.
5. If handle is required with a single member, please specify "with handle" at time of order.

### HOW TO PRICE

1. Select desired size and class of fit.
2. For chrome, add 100%.

<b>HELICOIL GAGES (STI)</b>			<b>Product Group #19-00THC</b>					
<b>Nominal Size</b>	<b>GO Member</b>		<b>NOGO Member</b>			<b>Double End w/Handle</b>		<b>Handle Only No.</b>
	<b>Class 2B or 3B</b>	<b>Class 2B</b>	<b>Class 3B</b>	<b>Class 2B</b>	<b>Class 3B</b>	<b>Class 2B</b>	<b>Class 3B</b>	
	<b>Item No.</b>	<b>Item No.</b>	<b>Item No.</b>	<b>Item No.</b>	<b>Item No.</b>	<b>Item No.</b>	<b>Item No.</b>	
2 56 UNC	M550400	M560400	M570400		M550456	M550457		00
4 40 UNC	M550900	M560900	M570900		M550956	M550957		00
6 32 UNC	M551300	M561300	M571300		M551356	M551357		0
8 32 UNC	M551500	M561500	M571500		M551556	M551557		0
10 24 UNC	M551700	M561700	M571700		M551756	M551757		0
10 32 UNF	M551800	M561800	M571800		M551856	M551857		0
1/4 20 UNC	M552200	M562200	M572200		M552256	M552257		1
1/4 28 UNF	M552300	M562300	M572300		M552356	M552357		1
5/16 18 UNC	M552500	M562500	M572500		M552556	M552557		2
5/16 24 UNF	M552600	M562600	M572600		M552656	M552657		2
3/8 16 UNC	M552800	M562800	M572800		M552856	M552857		2
3/8 24 UNF	M552900	M562900	M572900		M552956	M552957		2
7/16 20 UNF	M553200	M563200	M573200		M553256	M553257		3
1/2 13 UNC	M553400	M563400	M573400		M553456	M553457		3
1/2 20 UNF	M553500	M563500	M573500		M553556	M553557		3



# REVERSIBLE STEEL THREAD PLUG GAGES

## HOW TO ORDER

1. Specify quantity and type (members only, member with handle or double end with handle).
2. Specify nominal diameter and threads per inch GO and/or NOGO.
3. Select class of fit, 2B or 3B.
4. Special marking instructions, if any.
5. If handle is required with a single member, please specify "with handle" at time of order.

## HOW TO PRICE

1. Select desired size and class of fit.
2. For Chrome, add 100%.

## REVERSIBLE STYLE WORK PLUG GAGES Product Group #19-00W REV

Nominal Size			GO Member Item No.	NOGO Class 2B Item No.	Double End w/Handle Class 2B Item No.	Handle Only No.
0	80	UNF	M100100	M110100	M100111	1W
1	64	UNC	M100200	M110200	M100211	1W
1	72	UNF	M100300	M110300	M100311	1W
2	56	UNC	M100400	M110400	M100411	2W
2	64	UNF	M100500	M110500	M100511	2W
3	48	UNC	M100600	M110600	M100611	2W
3	56	UNF	M100700	M110700	M100711	2W
4	40	UNC	M100900	M110900	M100911	2W
4	48	UNF	M101000	M111000	M101011	2W
5	40	UNC	M101100	M111100	M101111	2W
5	44	UNF	M101200	M111200	M101211	2W
6	32	UNC	M101300	M111300	M101311	2W
6	40	UNF	M101400	M111400	M101411	2W
8	32	UNC	M101500	M111500	M101511	2W
8	36	UNF	M101600	M111600	M101611	2W
10	24	UNC	M101700	M111700	M101711	3W
10	32	UNF	M101800	M111800	M101811	3W
12	24	UNC	M101900	M111900	M101911	3W
12	28	UNF	M102000	M112000	M102011	3W
12	32	UNEF	M102100	M112100	M102111	3W
1/4	20	UNC	M102200	M112200	M102211	3W
1/4	28	UNF	M102300	M112300	M102311	3W
1/4	32	UNEF	M102400	M112400	M102411	3W
5/16	18	UNC	M102500	M112500	M102511	4W
5/16	24	UNF	M102600	M112600	M102611	4W
5/16	32	UNEF	M102700	M112700	M102711	4W
3/8	8-	UNC	M102800	M112800	M102811	4W
3/8	24	UNF	M102900	M112900	M102911	4W
3/8	32	UNEF	M103000	M113000	M103011	4W
7/16	14	UNC	M103100	M113100	M103111	5W
7/16	20	UNF	M103200	M113200	M103211	5W
7/16	28	UNEF	M103300	M113300	M103311	5W
1/2	13	UNC	M103400	M113400	M103411	5W
1/2	20	UNF	M103500	M113500	M103511	5W
1/2	28	UNEF	M103600	M113600	M103611	5W
9/16	12	UNC	M103700	M113700	M103711	6W
9/16	18	UNF	M103800	M113800	M103811	6W
9/16	24	UNEF	M103900	M113900	M103911	6W
5/8	11	UNC	M104000	M114000	M104011	6W
5/8	18	UNF	M104100	M114100	M104111	6W
5/8	24	UNEF	M104200	M114200	M104211	6W
11/16	24	UNEF	M104300	M114300	M104311	7W
3/4	10	UNC	M104400	M114400	M104411	7W
3/4	16	UNF	M104500	M114500	M104511	7W
3/4	20	UNEF	M104600	M114600	M104611	7W



# THREAD RING GAGES

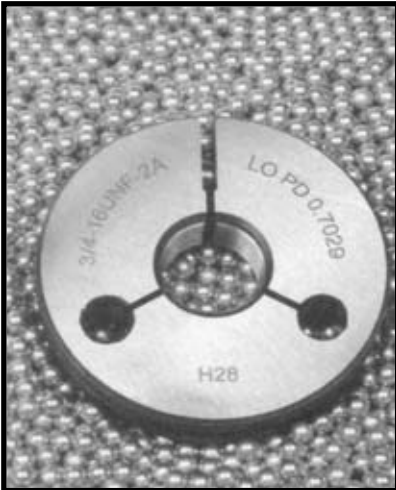

- Manufactured from selected graphite steels to American Gage Design (AGD Style).
- Machined and accurately lapped for an exacting thread size.
- Meticulously inspected in every element.
- Best if purchased with and mated to a setting plug gage at the time of order.
- NOGO rings are furnished with an identifying groove around the rim of the gage.
- Optional Thread Ring Gage Holders available, optional.
- Class 2 and Class 3 available on request.

## HOW TO ORDER

1. Specify nominal diameter, pitch and class of fit 2A, 3A, or Basic.
2. Setting Plugs should be ordered at the same time as the corresponding ring gages.
3. Request Ring Gages be set with new Set Plug before shipping.
4. Left hand available, price on application.
5. Larger sizes available, price on application.
6. Specials available, price on application.
7. Chrome available on rings, add 100%.

## RING GAGES

**Product Group #19-00R**

Nominal Size	GO Ring Gage		NOGO Ring Gage		Holder Only No.
	Class 2A Item No.	Class 3A/Basic Item No.	Class 2A Item No.	Class 3A Item No.	
0 80 UNF	M240100	M250100	M260100	M270100	1
1 64 UNC	M240200	M250200	M260200	M270200	1
1 72 UNF	M240300	M250300	M260300	M270300	1
2 56 UNC	M240400	M250400	M260400	M270400	1
2 64 UNF	M240500	M250500	M260500	M270500	1
3 48 UNC	M240600	M250600	M260600	M270600	1
3 56 UNF	M240700	M250700	M260700	M270700	1
4 40 UNC	M240900	M250900	M260900	M270900	1
4 48 UNF	M241000	M251000	M261000	M271000	1
5 40 UNC	M241100	M251100	M261100	M271100	1
5 44 UNF	M241200	M251200	M261200	M271200	1
6 32 UNC	M241300	M251300	M261300	M271300	1
6 40 UNF	M241400	M251400	M261400	M271400	1
8 32 UNC	M241500	M251500	M261500	M271500	1
8 36 UNF	M241600	M251600	M261600	M271600	1
10 24 UNC	M241700	M251700	M261700	M271700	1
10 32 UNF	M241800	M251800	M261800	M271800	1
12 24 UNC	M241900	M251900	M261900	M271900	1
12 28 UNF	M242000	M252000	M262000	M272000	1
12 32 UNEF	M242100	M252100	M262100	M272100	1
1/4 20 UNC	M242200	M252200	M262200	M272200	2
1/4 28 UNF	M242300	M252300	M262300	M272300	2
1/4 32 UNEF	M242400	M252400	M262400	M272400	2
5/16 18 UNC	M242500	M252500	M262500	M272500	2
5/16 24 UNF	M242600	M252600	M262600	M272600	2
5/16 32 UNEF	M242700	M252700	M262700	M272700	2
3/8 16 UNC	M242800	M252800	M262800	M272800	3
3/8 24 UNF	M242900	M252900	M262900	M272900	3
3/8 32 UNEF	M243000	M253000	M263000	M273000	3
7/16 14 UNC	M243100	M253100	M263100	M273100	3
7/16 20 UNF	M243200	M253200	M263200	M273200	3
7/16 28 UNEF	M243300	M253300	M263300	M273300	3
1/2 13 UNC	M243400	M253400	M263400	M273400	3
1/2 20 UNF	M243500	M253500	M263500	M273500	3
1/2 28 UNEF	M243600	M253600	M263600	M273600	3
9/16 12 UNC	M243700	M253700	M263700	M273700	4
9/16 18 UNF	M243800	M253800	M263800	M273800	4
9/16 24 UNEF	M243900	M253900	M263900	M273900	4



**RING GAGES (continued)**

**Product Group #19-00R**

Nominal Size	GO Ring Gage			NOGO Ring Gage		Holder Only No.
	Class 2A Item No.	Class 3A/Basic Item No.	Class 2A Item No.	Class 3A Item No.		
5/8 11 UNC	M244000	M254000	M264000	M274000	4	
5/8 18 UNF	M244100	M254100	M264100	M274100	4	
5/8 24 UNEF	M244200	M254200	M264200	M274200	4	
11/16 24 UNEF	M244300	M254300	M264300	M274300	4	
3/4 10 UNC	M244400	M254400	M264400	M274400	4	
3/4 16 UNF	M244500	M254500	M264500	M274500	4	
3/4 20 UNEF	M244600	M254600	M264600	M274600	4	
13/16 20 UNEF	M244700	M254700	M264700	M274700	4	
7/8 9 UNC	M244800	M254800	M264800	M274800	5	
7/8 14 UNF	M244900	M254900	M264900	M274900	5	
7/8 20 UNEF	M245000	M255000	M265000	M275000	5	
15/16 20 UNEF	M245100	M255100	M265100	M275100	5	
1 8 UNC	M245200	M255200	M265200	M275200	5	
1 12 UNF	M245300	M255300	M265300	M275300	5	
1 14 UNS	M245400	M255400	M265400	M275400	5	
1 20 UNEF	M245500	M255500	M265500	M275500	5	
1-1/16 18 UNEF	M245600	M255600	M265600	M275600	5	
1-1/8 8 UNC	M245700	M255700	M265700	M275700	5	
1-1/8 12 UNF	M245800	M255800	M265800	M275800	5	
1-1/8 18 UNEF	M245900	M255900	M265900	M275900	5	
1-3/16 18 UNEF	M246000	M256000	M266000	M276000	5	
1-1/4 7 UNC	M246100	M256100	M266100	M276100	6	
1-1/4 12 UNF	M246200	M256200	M266200	M276200	6	
1-1/4 18 UNEF	M246300	M256300	M266300	M276300	6	
1-5/16 18 UNEF	M246400	M256400	M266400	M276400	6	
1-3/8 6 UNC	M246500	M256500	M266500	M276500	6	
1-3/8 12 UNF	M246600	M256600	M266600	M276600	6	
1-3/8 18 UNEF	M246700	M256700	M266700	M276700	6	
1-7/16 18 UNEF	M246800	M256800	M266800	M276800	6	
1-1/2 6 UNC	M246900	M256900	M266900	M276900	6	
1-1/2 12 UNF	M247000	M257000	M267000	M277000	6	
1-1/2 18 UNEF	M247100	M257100	M267100	M277100	6	



# TRUNCATED THREAD SETTING PLUGS

- Truncated type thread setting plugs have a full form threaded portion and a truncated portion.
- The full form portion checks the pitch diameter and major diameter clearance.
- The Truncated portion checks pitch diameter and flank angle wear.
- Made from selected steels, ground and accurately lapped.
- Meticulously inspected in every thread element.
- Standard thread setting plugs are Class X tolerance on pitch diameter, while holding "W" tolerance on lead and angles.
- For Class "W" tolerance on pitch diameter, add 50%.

## HOW TO ORDER

1. Specify Quantity.
2. Specify nominal size, pitch and class of fit 2A or 3A.
3. Handles are not included with single members. If handles are required for GO or NOGO members, specify "with handles" at time of order.
4. Setting Plugs should be ordered at the same time as the corresponding ring gages.
5. Request Ring Gages be set with new Set Plug before shipping.
6. For Class "W" tolerance, add 50%.
7. Left hand available, price on application.
8. Specials available, price on application.

## TRUNCATED SETTING PLUGS Product Group #19-00S

Nominal Size	GO Member		NOGO Member		GO-NOGO w/handle		Handle Only No.
	Class 2A Item No.	Class 3A/Basic Item No.	Class 2A Item No.	Class 3A Item No.	Class 2A Item No.	Class 3A Item No.	
0 80 UNF	M300100	M310100	M320100	M330100	M300132	M310133 \$	000
1 64 UNC	M300200	M310200	M320200	M330200	M300232	M310233	000
1 72 UNF	M300300	M310300	M320300	M330300	M300332	M310333	000
2 56 UNC	M300400	M310400	M320400	M330400	M300432	M310433	000
2 64 UNF	M300500	M310500	M320500	M330500	M300532	M310533	000
3 48 UNC	M300600	M310600	M320600	M330600	M300632	M310633	000
3 56 UNF	M300700	M310700	M320700	M330700	M300732	M310733	000
4 40 UNC	M300900	M310900	M320900	M330900	M300932	M310933	00
4 48 UNF	M301000	M311000	M321000	M331000	M301032	M311033	00
5 40 UNC	M301100	M311100	M321100	M331100	M301132	M311133	00
5 44 UNF	M301200	M311200	M321200	M331200	M301232	M311233	00
6 32 UNC	M301300	M311300	M321300	M331300	M301332	M311333	00
6 40 UNF	M301400	M311400	M321400	M331400	M301432	M311433	00
8 32 UNC	M301500	M311500	M321500	M331500	M301532	M311533	0
8 36 UNF	M301600	M311600	M321600	M331600	M301632	M311633	0
10 24 UNC	M301700	M311700	M321700	M331700	M301732	M311733	0
10 32 UNF	M301800	M311800	M321800	M331800	M301832	M311833	0
12 24 UNC	M301900	M311900	M321900	M331900	M301932	M311933	0
12 28 UNF	M302000	M312000	M322000	M332000	M302032	M312033	0
12 32 UNEF	M302100	M312100	M322100	M332100	M302132	M312133	0
1/4 20 UNC	M302200	M312200	M322200	M332200	M302232	M312233	1
1/4 28 UNF	M302300	M312300	M322300	M332300	M302332	M312333	1
1/4 32 UNEF	M302400	M312400	M322400	M332400	M302432	M312433	1
5/16 18 UNC	M302500	M312500	M322500	M332500	M302532	M312533	1
5/16 24 UNF	M302600	M312600	M322600	M332600	M302632	M312633	1
5/16 32 UNEF	M302700	M312700	M322700	M332700	M302732	M312733	1
3/8 16 UNC	M302800	M312800	M322800	M332800	M302832	M312833	2
3/8 24 UNF	M302900	M312900	M322900	M332900	M302932	M312933	2
3/8 32 UNEF	M303000	M313000	M323000	M333000	M303032	M313033	2
7/16 14 UNC	M303100	M313100	M323100	M333100	M303132	M313133	2
7/16 20 UNF	M303200	M313200	M323200	M333200	M303232	M313233	2
7/16 28 UNEF	M303300	M313300	M323300	M333300	M303332	M313333	2

continued on the next page



# TRUNCATED THREAD SETTING PLUGS

## TRUNCATED SETTING PLUGS (continued)

## Product Group #19-00S

Nominal Size	GO Member			NOGO Member		GO-NOGO w/handle		Handle Only No.
	Class 2A Item No.	Class 3A/Basic Item No.	Class 2A Item No.	Class 3A Item No.	Class 2A Item No.	Class 3A Item No.		
1/2 13 UNC	M303400	M313400	M323400	M333400	M303432	M313433	2	
1/2 20 UNF	M303500	M313500	M323500	M333500	M303532	M313533	2	
1/2 28 UNEF	M303600	M313600	M323600	M333600	M303632	M313633	2	
9/16 12 UNC	M303700	M313700	M323700	M333700	M303732	M313733	3	
9/16 18 UNF	M303800	M313800	M323800	M333800	M303832	M313833	3	
9/16 24 UNEF	M303900	M313900	M323900	M333900	M303932	M313933	3	
5/8 11 UNC	M304000	M314000	M324000	M334000	M304032	M314033	3	
5/8 18 UNF	M304100	M314100	M324100	M334100	M304132	M314133	3	
5/8 24 UNEF	M304200	M314200	M324200	M334200	M304232	M314233	3	
11/16 24 UNEF	M304300	M314300	M324300	M334300	M304332	M314333	3	
3/4 10 UNC	M304400	M314400	M324400	M334400	M304432	M314433	3	
3/4 16 UNF	M304500	M314500	M324500	M334500	M304532	M314533	3	
3/4 20 UNEF	M304600	M314600	M324600	M334600	M304632	M314633	3	
13/16 20 UNEF	M304700	M314700	M324700	M334700	M304732	M314733	3	
7/8 8 UNC	M304800	M314800	M324800	M334800	M304832	M314833	4	
7/8 14 UNF	M304900	M314900	M324900	M334900	M304932	M314933	4	
7/8 20 UNEF	M305000	M315000	M325000	M335000	M305032	M315033	4	
15/16 20 UNEF	M305100	M315100	M325100	M335100	M305132	M315133	4	
1 8 UNC	M305200	M315200	M325200	M335200	M305232	M315233	4	
1 12 UNF	M305300	M315300	M325300	M335300	M305332	M315333	4	
1 14 UNS	M305400	M315400	M325400	M335400	M305432	M315433	4	
1 20 UNEF	M305500	M315500	M325500	M335500	M305532	M315533	4	
1-1/16 18 UNEF	M305600	M315600	M325600	M335600	M305632	M315633	4	
1-1/8 7 UNC	M305700	M315700	M325700	M335700	M305732	M315733	4	
1-1/8 12 UNF	M305800	M315800	M325800	M335800	M305832	M315833	4	
1-1/8 18 UNEF	M305900	M315900	M325900	M335900	M305932	M315933	4	
1-3/16 18 UNEF	M306000	M316000	M326000	M336000	M306032	M316033	5	
1-1/4 7 UNC	M306100	M316100	M326100	M336100	M306132	M316133	5	
1-1/4 12 UNF	M306200	M316200	M326200	M336200	M306232	M316233	5	
1-1/4 18 UNEF	M306300	M316300	M326300	M336300	M306332	M316333	5	
1-5/16 18 UNEF	M306400	M316400	M326400	M336400	M306432	M316433	5	
1-3/8 6 UNC	M306500	M316500	M326500	M336500	M306532	M316533	5	
1-3/8 12 UNF	M306600	M316600	M326600	M336600	M306632	M316633	5	
1-3/8 18 UNEF	M306700	M316700	M326700	M336700	M306732	M316733	5	
1-7/16 18 UNEF	M306800	M316800	M326800	M336800	M306832	M316833	5	
1-1/2 6 UNC	M306900	M316900	M326900	M336900	M306932	M316933	5	
1-1/2 12 UNF	M307000	M317000	M327000	M337000	M307032	M317033	5	
1-1/2 18 UNEF	M307100	M317100	M327100	M337100	M307132	M317133	18.5	

The shanks on the gaging members are tapered to fit corresponding tapered holes in the handle.  
Worn members may be removed and the handle salvaged for use with new members.  
Member sizes 0-6 have a male point in addition to the lengths shown.





# METRIC STEEL TAPERLOCK THREAD PLUG GAGES

- Standard in 6H tolerance.
- For Taperlocks with chrome, add 100%.
- Left hand available, price on application
- Larger sizes available, price on application.

## HOW TO ORDER

1. Specify quantity.
2. Specify nominal diameter and threads per inch.
3. Specify special markings instructions, if any.

## HOW TO PRICE

1. Select desired size

## **METRIC STEEL TAPERLOCK THREAD PLUG GAGES** **Product Group #19-00MT**

Metric Size & Pitch	GO Member Item No.	NOGO Member Item No.	Double End w/Handle Item No.	Handle Only Size
M1.6 X 0.35	M20100901	M20100913	M20100963	000
M1.8 X 0.35	M20101101	M20101113	M20101163	000
M2.0 X 0.40	M20101301	M20101313	M20101363	000
M2.2 X 0.45	M20101501	M20101513	M20101563	000
M2.5 X 0.45	M227200	M237200	M227223	000
M3.0 X 0.50	M227300	M237300	M227323	00
M3.5 X 0.60	M227400	M237400	M227423	00
M4.0 X 0.70	M227500	M237500	M227523	0
M4.5 X 0.75	M20102501	M20102513	M20102563	0
M5.0 X 0.80	M227600	M237600	M227623	0
M6.0 X 1.00	M227700	M237700	M227723	1
M7.0 X 1.00	M20103201	M20103213	M20103263	1
M8.0 X 1.00	M20103501	M20103513	M20103563	1
M8.0 X 1.25	M227800	M237800	M227823	1
M10.0 X 1.50	M228000	M238000	M228023	2
M10.0 X 1.25	M228100	M238100	M228123	2
M12.0 X 1.75	M228300	M238300	M228323	2
M12.0 X 12.00	M228400	M238400	M228423	2
M12.0 X 1.25	M228500	M238500	M228523	2
M14.0 X 2.00	M228700	M238700	M228723	3
M14.0 X 1.50	M228800	M238800	M228823	3
M16.0 X 2.00	M229000	M239000	M229023	3
M16.0 X 1.50	M229100	M239100	M229123	3
M17.0 X 1.00	M229200	M239200	M229223	3
M18.0 X 2.50	M20106201	M20106213	M20106263	3
M18.0 X 1.50	M229300	M239300	M229323	3
M20.0 X 2.50	M229400	M239400	M229423	3
M20.0 X 1.50	M229500	M239500	M229523	3
M22.0 X 2.50	M20107001	M20107013	M20107063	4
M22.0 X 1.50	M20107201	M20107213	M20107263	4
M24.0 X 3.00	M20107401	M20107413	M20107463	4
M24.0 X 2.00	M20107501	M20107513	M20107563	4
M27.0 X 3.00	M20108201	M20108213	M20108263	4
M27.0 X 2.00	M20108301	M20108313	M20108363	4
M30.0 X 3.50	M20108901	M20108913	M20108963	5
M30.0 X 2.00	M20109101	M20109113	M20109163	5
M33.0 X 3.50	M20109601	M20109613	M20109663	5
M33.0 X 2.00	M20109801	M20109813	M20109863	5
M36.0 X 4.00	M20110101	M20110113	M20110163	5
M36.0 X 3.00	M20110201	M20110213	M20110263	5



# REVERSIBLE METRIC STEEL THREAD PLUGS

- Standard in 6H tolerance.
- For chrome, add 100%.
- Left hand available, price on application
- Larger sizes available, price on application.

## HOW TO ORDER

1. Specify quantity.
2. Specify nominal diameter and threads per inch.
3. Specify special markings instructions, if any.

## HOW TO PRICE

1. Select desired size

### **REVERSIBLE METRIC THREAD PLUGS** **Product Group #19-00H**

Metric Size & Pitch Coarse	Go Member Item No.	No Go Member Item No.	Double End w/Handle Item No.	Handle Only No.
M2.5 X 0.45	M207200	M217200	M207221	2W
M3.0 X 0.50	M207300	M217300	M207321	2W
M3.5 X 0.60	M207400	M217400	M207421	2W
M4.0 X 0.70	M207500	M217500	M207521	2W
M5.0 X 0.80	M207600	M217600	M207621	3W
M6.0 X 1.00	M207700	M217700	M207721	3W
M8.0 X 1.25	M207800	M217800	M207821	4W
M8.0 X 1.60	M207900	M217900	M207921	4W
M10.0 X 1.50	M208000	M218000	M208021	4W
M10.0 X 1.25	M208100	M218100	M208121	4W
M12.0 X 1.75	M208300	M218300	M208321	5W
M12.0 X 1.25	M208500	M218500	M208521	5W
M14.0 X 2.00	M208700	M218700	M208721	6W
M14.0 X 1.50	M208800	M218800	M208821	6W
M16.0 X 2.00	M209000	M219000	M209021	6W
M16.0 X 1.50	M209100	M219100	M209121	6W
M18.0 X 1.50	M209300	M219300	M209321	7W

### **METRIC - INCH PITCH EQUIVALENTS**

Pitch mm	Pitch in Inches	Threads Per Inch	Pitch mm	Pitch in Inches	Threads Per Inch
0.35	.01378	72.57	1.25	.04921	20.32
0.40	.01575	63.50	1.50	.05906	16.93
0.45	.01772	56.44	1.75	.06890	14.51
0.50	.01969	50.80	2.00	.07874	12.70
0.60	.02362	42.33	2.50	.09843	10.16
0.70	.02756	36.29	3.00	.11811	8.46
0.75	.02953	33.87	4.00	.15748	6.35
0.80	.03150	31.75	4.50	.17717	5.64
0.90	.03543	28.22	5.00	.19685	5.08
1.00	.03937	25.40	6.00	.23622	4.23



## METRIC THREAD RING GAGES

- Standard in 6g Tolerance.
- Manufactured from selected steels to American Gage Design (AGD Style).
- Machined and accurately lapped for an exacting thread size.
- Meticulously inspected in every element.
- Best if purchased with and mated to a setting plug gage at the time of order.
- NOGO rings are furnished with an identifying groove around the rim of the gage.
- Optional Thread Ring Gage Holders available.
- Chrome Plate Rings, add 50%.
- Left hand available, price on application.
- Larger sizes available, price on application

### HOW TO ORDER

1. Standard in 6g tolerance.
2. Setting Plugs should be ordered at the same time as the corresponding ring gages.
3. Ring Gages will be set with new Set Plug before shipping.
4. Chrome available on rings, add 100%.
5. Left hand available, price on application.
6. Larger sizes available, price on application.
7. Specials available, price on application.

### **METRIC THREAD RINGS**

**Product Group #19-00MR**

Nominal Size Pitch mm	GO Ring Item No.	NOGO Ring Item No.	GO-NOGO w/o holder Item No.	Holder Size
M1.6 X 0.35	M27100901	M27100913	M27100963	1
M1.8 X 0.35	M27101101	M27101113	M27101163	1
M2.0 X 0.40	M27101301	M27101313	M27101363	1
M2.2 X 0.45	M27101501	M27101513	M27101563	1
M2.5 X 0.45	M367200	M377200	M367237	1
M3.0 X 0.50	M367300	M377300	M367337	1
M3.5 X 0.60	M367400	M377400	M367437	1
M4.0 X 0.70	M367500	M377500	M27102563	1
M4.5 X 0.75	M27102501	M27102513	M367537	1
M5.0 X 0.80	M367600	M377600	M367637	1
M6.0 X 1.00	M367700	M377700	M367737	2
M7.0 X 1.00	M27103201	M27103213	M27103263	2
M8.0 X 1.25	M367800	M377800	M367837	2
M8.0 X 1.00	M367900	M377900	M367937	2
M10.0 X 1.50	M368000	M378000	M368037	3
M10.0 X 1.25	M368100	M378100	M368137	3
M12.0 X 1.75	M368300	M378300	M368337	3
M12.0 X 1.50	M368400	M378400	M368437	3
M12.0 X 1.25	M368500	M378500	M368537	3
M14.0 X 2.00	M368700	M378700	M368737	4
M14.0 X 1.50	M368800	M378800	M368837	4
M16.0 X 2.00	M369000	M379000	M369037	4
M16.0 X 1.50	M369100	M379100	M369137	4
M17.0 X 1.00	M369200	M379200	M369237	4
M18.0 X 2.50	M27106201	M27106213	M27106263	4
M18.0 X 1.50	M369300	M379300	M369337	4
M20.0 X 2.50	M369400	M379400	M369437	4
M20.0 X 1.50	M369500	M379500	M369537	4
M22.0 X 2.50	M27107001	M27107013	M27107063	5
M22.0 X 1.50	M27107201	M27107213	M27107263	5
M24.0 X 3.00	M27107401	M27107413	M27107463	5
M24.0 X 2.00	M27107501	M27107513	M27107563	5
M27.0 X 3.00	M27108201	M27108213	M27108263	5
M27.0 X 2.00	M27108301	M27108313	M27108363	5
M30.0 X 3.50	M27108901	M27108913	M27108963	6
M30.0 X 2.00	M27109101	M27109113	M27109163	6
M33.0 X 3.50	M27109601	M27109613	M27109663	6
M33.0 X 2.00	M27109801	M27109813	M27109863	6
M36.0 X 4.00	M27110101	M27110113	M27110163	6
M36.0 X 3.00	M27110201	M27110213	M27110263	6



# METRIC THREAD SETTING PLUGS

- Standard in 6g Tolerance.
- Left hand available, price on application.
- Larger sizes available, price on application

## HOW TO ORDER

1. Standard in 6g Tolerance.
2. Specify Quantity.
3. Handles are not included with single members. If handles are required for GO or NOGO members, specify "with handles" at time of order.
4. Setting Plugs should be ordered at the same time as the corresponding ring gages.
5. Request Ring Gages be set with new Set Plug before shipping.
6. For class "W" tolerance, add 25%.
7. Left hand available, price on application.
8. Specials available, price on application.
9. When ordering please use item numbers.

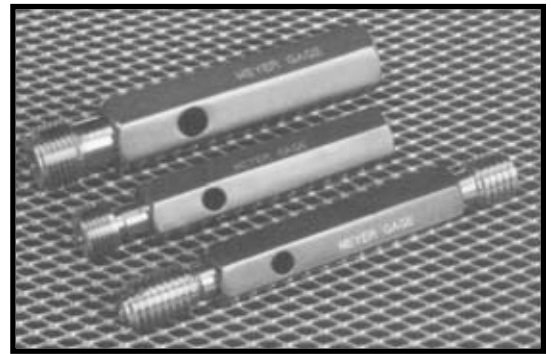

## **TRUNCATED SETTING PLUGS** **Product Group #19-00MS**

Metric Size Pitch mm	GO Member Item No.	NOGO Member Item No.	Double End w/Handle Item No.	Handle Only No
M1.6 X 0.35	M23600901	M23600913	M23600963	000
M1.8 X 0.35	M23601101	M23601113	M23601163	000
M2.0 X 0.40	M23601301	M23601313	M23601363	000
M2.2 X 0.45	M23601501	M23601513	M23601563	000
M2.5 X 0.45	M387200	M397200	M387239	000
M3.0 X 0.50	M387300	M397300	M387339	00
M3.5 X 0.60	M387400	M397400	M387439	00
M4.0 X 0.70	M387500	M397500	M387539	0
M4.5 X 0.75	M23602501	M23602513	M23602563	0
M4.5 X 0.75	M387600	M397600	M387639	0
M6.0 X 1.00	M387700	M397700	M387739	1
M7.0 X 1.00	M23603201	M23603213	M23603263	1
M8.0 X 1.25	M387800	M397800	M387839	1
M8.0 X 1.00	M387900	M397900	M387939	1
M10.0 X 1.50	M388000	M398000	M388039	2
M10.0 X 1.25	M388100	M398100	M388139	2
M12.0 X 1.75	M388300	M398300	M388339	2
M12.0 X 1.50	M388400	M398400	M388439	2
M12.0 X 1.25	M388500	M398500	M388539	2
M14.0 X 2.00	M388700	M398700	M388739	3
M14.0 X 1.50	M388800	M398800	M388839	3
M16.0 X 2.00	M389000	M399000	M389039	3
M16.0 X 1.50	M389100	M399100	M389139	3
M17.0 X 1.00	M389200	M399200	M389239	3
M18.0 X 2.50	M23606201	M23606213	M23606263	3
M18.0 X 1.50	M389300	M399300	M389339	3
M20.0 X 2.50	M389400	M399400	M389439	3
M20.0 X 1.50	M389500	M399500	M389539	3
M22.0 X 2.50	M23607001	M23607013	M23607063	4
M22.0 X 1.50	M23607201	M23607213	M23607263	4
M24.0 X 3.00	M23607401	M23607413	M23607463	4
M24.0 X 2.00	M23607501	M23607513	M23607563	4
M27.0 X 3.00	M23608201	M23608213	M23608263	4
M27.0 X 2.00	M23608301	M23608313	M23608363	4
M30.0 X 3.00	M23608901	M23608913	M23608963	5
M30.0 X 2.00	M23609101	M23609113	M23609163	5
M33.0 X 3.50	M23609601	M23609613	M23609663	5
M33.0 X 2.00	M23609801	M23609813	M23609863	5
M36.0 X 4.00	M23610101	M23610113	M23610163	5
M36.0 X 3.00	M23610201	M23610213	M23610263	5



# TAPER PIPE GAGES — NPT

American National Taper Pipe Thread Gages (NPT) are furnished to thread specifications which are in agreement with the National Institute of Standards and Technology American Gage Design dimensions as shown below.

Master and reference gages can be furnished on request.

## TAPER PIPE GAGES - NPT

- (NPT) are furnished American National Pipe Thread NPT TAPER PIPE GAGES made to American Gage Dimensions (AGD).
- To thread specifications which are in agreement with National Institute of Standards.
- Larger sizes and ANPT available upon request.

## ADDITIONAL PIPE THREAD GAGES

- Straight Pipe: NPSF, NPSL, NPSC, NPSM and other special pipe gages available upon request.

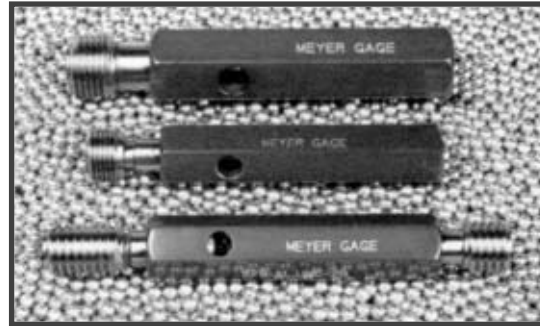

### TAPER PIPE GAGES - NPT DIMENSIONS

### RING DIMENSIONS

Nominal Size	Plug Dimensions			D Taper- Lock Only	No.	Handle		Ring Dimensions				
	Length Member L <sub>1</sub> to Notch Tolerance	Length L <sub>2</sub> Min.	Minus			Length H	Hex	Nominal Size	Thickness L <sub>1</sub> Thin	Tolerance Plus	A Outside Dia.	
1/16	27	.1600	.001	.261	1/4	1	2-3/4	3/8	1/16	.1600	.001	1-1/8
1/8	27	.1615	.001	.264	1/4	2	3	1/2	1/8	.1615	.001	1-1/8
1/4	18	.2278	.001	.402	1/4	3	3-1/4	11/16	1/4	.2278	.001	1-3/8
3/8	18	.2400	.001	.408	1/4	3	3-1/4	11/16	3/8	.2400	.001	1-1/2
1/2	14	.3200	.001	.534	5/16	4	3-5/8	7/8	1/2	.3200	.001	1-3/4
3/4	14	.3390	.001	.546	5/16	4	3-5/8	7/8	3/4	.3390	.001	2
1	11-1/2	.4000	.001	.683	3/8	5	4	1	1	.4000	.001	2-1/2
1-1/4	11-1/2	.4200	.001	.707	3/8	5	4	1	1-1/4	.4200	.001	3
1-1/2	11-1/2	.4200	.001	.723	3/8	5	4	1	1-1/2	.4200	.001	3-1/4
2	11-1/2	.4360	.001	.757	3/8	5	4	1	2	.4360	.001	3-3/4
2-1/2	8	.6820	.002	1.138	—	6	5	1-1/8	2-1/2	.6820	.002	4-1/4
3	8	.7660	.002	1.200	—	6	5	1-1/8	3	.7660	.002	5

### L<sub>1</sub> SINGLE END PLUG GAGES - NPT #19-00TP

### L<sub>1</sub> THIN RING GAGES - NPT #19-00TP

Nominal Size	L <sub>1</sub> Plug Gage Item No.	L <sub>1</sub> Plug Gage w/Handle Item No.	Handle Price	Handle No.	Nominal Size	Item No.	
1/16	27	M701140	M7011401	1	1/16	27	M701152
1/8	27	M701141	M7011411	2	1/8	27	M701153
1/4	18	M701142	M7011421	3	1/4	18	M701154
3/8	18	M701143	M7011431	3	3/8	18	M701155
1/2	14	M701144	M7011441	4	1/2	14	M701156
3/4	14	M701145	M7011451	4	3/4	14	M701157
1	11-1/2	M701146	M7011461	5	1	11-1/2	M701158
1-1/4	11-1/2	M701147	M7011471	5	1-1/4	11-1/2	M701159
1-1/2	11-1/2	M701148	M7011481	5	1-1/2	11-1/2	M701160
2	11-1/2	M701149	M7011491	5	2	11-1/2	M701161
2-1/2	8	M701150	M7011501	6	2-1/2	8	M701162
3	8	M701151	M7011511	6	3	8	M701163



## NPTF (Dryseal) Taper Pipe Gages

Dryseal pipe threads are generally used in more critical applications than NPT and, therefore, a greater variety of gages and/or measuring equipment is used to more adequately check size, taper, and thread form.

- $L_1$  and  $L_3$  plugs supplied with 1 step as standard
- $L_1$  = Length of engagement in hand tight make up
- $L_2$  = Length of effective thread (external)
- $L_3$  = Length of 3 threads beyond  $L_1$  for wrench make up.

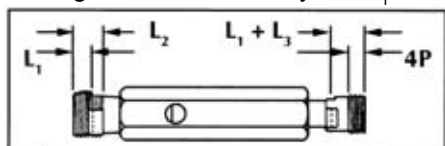

• Plug Dimensions

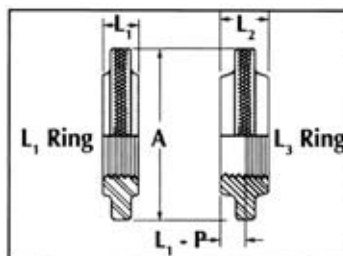

• Ring Dimensions

## TAPER PIPE GAGES — NPTF DIMENSIONS

Nominal Size	To Basic Notch	Length Member $L_1$ and $L_2$				Tol. Minus	Handle No.	Nominal Size	Outside Diameter	Thickness		
		Tol. Minus	Full Length (Min)	$L_2$	$L_1 + L_2$					$L_1$ Thin	$L_2$ Thick	Tol. Plus
1/16	.1600	.001	.26113	.2711	.001	1	1/16	1-1/8	.1600	.26113	.001	
1/8	.1615	.001	.26385	.2726	.001	2	1/8	1-1/8	.1615	.26385	.001	
1/4	.2278	.001	.40178	.3945	.001	3	1/4	1-3/8	.2278	.40178	.001	
3/8	.2400	.001	.40778	.4067	.001	3	3/8	1-1/2	.2400	.40778	.001	
1/2	.3200	.001	.53371	.5343	.001	4	1/2	1-3/4	.3200	.53371	.001	
3/4	.3390	.001	.54571	.5533	.001	4	3/4	2	.3390	.54571	.001	
1	.4000	.001	.68278	.6609	.001	5	1	2-1/2	.4000	.68278	.001	
1-1/4	.4200	.001	.70678	.6809	.001	5	1-1/4	3	.4200	.70678	.001	
1-1/2	.4200	.001	.72348	.6809	.001	5	1-1/2	3-1/4	.4200	.72348	.001	
2	.4360	.001	.75652	.6969	.001	5	2	3-3/4	.4360	.75652	.001	
2-1/2	.6820	.002	1.13750	1.0570	.002	6	2-1/2	4-1/4	.6820	1.13750	.002	
3	.7660	.002	1.20000	1.1410	.002	6	3	5	.7660	1.20000	.002	

## TAPER PIPE GAGES — NPTF

## Product Group #19-00TPF

Nominal Size	Item No.	$L_1$ Ring Gage Member Only		$L_2$ Ring Gage Member Only		NPTF 6 Step Plug Gage		NPTF 6 Step Ring Gage	
		Item No.	Item No.	Item No.	Item No.	Item No.	Item No.	Item No.	Item No.
1/16	27	M701185	M701192	M701178	M7011781	M701199			
1/8	27	M701186	M701193	M701179	M7011791	M701200			
1/4	18	M701187	M701194	M701180	M7011801	M701201			
3/8	18	M701188	M701195	M701181	M7011811	M701202			
1/2	14	M701189	M701196	M701182	M7011821	M701203			
3/4	14	M701190	M701197	M701183	M7011831	M701204			
1	11-1/2	M701191	M701198	M701184	M7011841	M701205			
1-1/4	11-1/2	M31600801	M31600804	M31100807	M31100857	M31600807			
1-1/2	11-1/2	M31600901	M31600904	M31100907	M31100957	M31600907			
2	11-1/2	M31601001	M31601004	M31101007	M31101057	M31601007			
2-1/2	8	M31601101	M31601104	M31101107	M31101157	M31601107			
3	8	M31601201	M31601204	M31101207	M31101257	M31601207			

Nominal Size	Item No.	$L_1$ Plug Gage		$L_3$ Plug Gage		$L_1$ & $L_3$ Double End w/Handle Item No.
		Member Only Item No.	w/Handle Item No.	Member Only Item No.	w/Handle Item No.	
1/16	27	M701164	M7011641	M701171	M7011711	M37401
1/8	27	M701165	M7011651	M701172	M7011721	M37403
1/4	18	M701166	M7011661	M701173	M7011731	M37405
3/8	18	M701167	M7011671	M701174	M7011741	M37407
1/2	14	M701168	M7011681	M701175	M7011751	M37409
3/4	14	M701169	M7011691	M701176	M7011761	M37411
1	11-1/2	M701170	M7011701	M701177	M7011771	M37413
1-1/4	11-1/2	M31100801	M31100851	M31100804	M31100854	M31100863
1-1/2	11-1/2	M31100901	M31100951	M31100904	M31100954	M31100963
2	11-1/2	M31101001	M31101051	M31101004	M31101054	M31101063
2-1/2	8	M31101101	M31101151	M31101104	M31101154	M31101163
3	8	M31101201	M31101251	M31101204	M31101254	M31101263



# TABLE OF THREAD PITCH DIAMETER LIMITS

Nominal Size Threads Per Inch and Series	Thread Ring Gages (External Threads)					Basic P.D.	Thread Plug Gages (Internal Threads)				
	Unified Series			National Series			1B	Unified Series		National Series	
	1A	2A	3A	2	3			2B	3B	2	3
0 (.060) - 80 NF	.0514	.0519	.0519	.0519	.0519	.0519	.0519	.0519	.0519	.0519	
	.0496	.0506	.0502	.0506			.0542	.0536	.0536	.0532	
1 (.073) - 64 NC	.0623	.0629	.0629	.0629	.0629		.0629	.0629	.0629	.0629	
	.0603	.0614	.0610	.0615			.0655	.0648	.0648	.0643	
1 (.073) - 72 NF	.0634	.0640	.0640	.0640	.0640		.0640	.0640	.0640	.0640	
	.0615	.0626	.0622	.0627			.0665	.0659	.0658	.0653	
2 (.086) - 56 NC	.0738	.0744	.0744	.0744	.0744		.0744	.0744	.0744	.0744	
	.0717	.0728	.0724	.0729			.0772	.0765	.0764	.0759	
2 (.086) - 64 NF	.0753	.0759	.0759	.0759	.0759		.0759	.0759	.0759	.0759	
	.0733	.0744	.0740	.0745			.0786	.0779	.0778	.0773	
3 (.099) - 48 NC	.0848	.0855	.0855	.0855	.0855		.0855	.0855	.0855	.0855	
	.0825	.0838	.0833	.0839			.0885	.0877	.0877	.0871	
3 (.099) - 56 NF	.0867	.0874	.0874	.0874	.0874		.0874	.0874	.0874	.0874	
	.0845	.0858	.0854	.0859			.0902	.0895	.0894	.0889	
4 (.112) - 40 NC	.0950	.0958	.0958	.0958	.0958		.0958	.0958	.0958	.0958	
	.0925	.0939	.0934	.0941			.0991	.0982	.0982	.0975	
4 (.112) - 48 NF	.0978	.0985	.0985	.0985	.0985		.0985	.0985	.0985	.0985	
	.0954	.0967	.0963	.0969			.1016	.1008	.1007	.1001	
5 (.125) - 40 NC	.1080	.1088	.1088	.1088	.1088		.1088	.1088	.1088	.1088	
	.1054	.1069	.1064	.1071			.1121	.1113	.1112	.1105	
5 (.125) - 44 NF	.1095	.1102	.1102	.1102	.1102		.1102	.1102	.1102	.1102	
	.1070	.1083	.1079	.1086			.1134	.1126	.1125	.1118	
6 (.138) - 32 NC	.1169	.1177	.1177	.1177	.1177		.1177	.1177	.1177	.1177	
	.1141	.1156	.1150	.1158			.1214	.1204	.1204	.1196	
6 (.138) - 40 NF	.1210	.1218	.1218	.1218	.1218		.1218	.1218	.1218	.1218	
	.1184	.1198	.1194	.1201			.1252	.1243	.1242	.1235	
8 (.164) - 32 NC	.1428	.1437	.1437	.1437	.1437		.1437	.1437	.1437	.1437	
	.1399	.1415	.1410	.1418			.1475	.1465	.1464	.1456	
8 (.164) - 36 NF	.1452	.1460	.1460	.1460	.1460		.1460	.1460	.1460	.1460	
	.1424	.1439	.1435	.1442			.1496	.1487	.1485	.1478	
10 (.190) - 24 NC	.1619	.1629	.1629	.1629	.1629		.1629	.1629	.1629	.1629	
	.1586	.1604	.1606	.1605			.1672	.1661	.1662	.1653	
10 (.190) - 32 NF	.1688	.1697	.1697	.1697	.1697		.1697	.1697	.1697	.1697	
	.1658	.1674	.1670	.1678			.1736	.1726	.1724	.1716	
12 (.216) - 24 NC	.1879	.1889	.1889	.1889	.1889		.1889	.1889	.1889	.1889	
	.1845	.1863	.1856	.1865			.1933	.1922	.1922	.1913	
12 (.216) - 28 NF	.1918	.1928	.1928	.1928	.1928		.1928	.1928	.1928	.1928	
	.1886	.1904	.1897	.1906			.1970	.1959	.1959	.1950	
12 (.216) - 32 NEF	.1948	.1957	.1957	.1957	.1957		.1957	.1957	.1957	.1957	
	.1917	.1933	.1926	.1935			.1998	.1988	.1988	.1979	
1/4" - 20 NC	.2164	.2164	.2175	.2175	.2175	.2175	.2175	.2175	.2175	.2175	
	.2108	.2127	.2147	.2139	.2149		.2248	.2224	.2211	.2201	
1/4" - 28 NF	.2258	.2258	.2268	.2268	.2268	.2268	.2268	.2268	.2268	.2268	
	.2208	.2225	.2243	.2237	.2246		.2333	.2311	.2300	.2299	
1/4" - 32 NEF	.2287	.2297	.2297	.2297	.2297	.2297	.2297	.2297	.2297	.2297	
	.2255	.2273	.2265	.2275			.2339	.2328	.2329	.2319	
5/16" - 18 NC	.2752	.2752	.2764	.2764	.2764	.2764	.2764	.2764	.2764	.2764	
	.2691	.2712	.2734	.2723	.2734		.2843	.2817	.2803	.2805	
5/16" - 24 NF	.2843	.2843	.2854	.2854	.2854	.2854	.2854	.2854	.2854	.2854	
	.2788	.2806	.2827	.2821	.2830		.2925	.2902	.2890	.2887	
5/16" - 32 NEF	.2912	.2922	.2922	.2922	.2922	.2922	.2922	.2922	.2922	.2922	
	.2880	.2898	.2889	.2899			.2964	.2953	.2955	.2945	
3/8" - 16 NC	.3331	.3331	.3344	.3344	.3344	.3344	.3344	.3344	.3344	.3344	
	.3266	.3287	.3311	.3299	.3312		.3429	.3401	.3387	.3389	
3/8" - 24 NF	.3468	.3468	.3479	.3479	.3479	.3479	.3479	.3479	.3479	.3479	
	.3411	.3430	.3450	.3446	.3455		.3553	.3528	.3516	.3512	
3/8" - 32 NEF	.3537	.3547	.3547	.3547	.3547	.3547	.3547	.3547	.3547	.3547	
	.3503	.3522	.3513	.3523			.3591	.3580	.3581	.3571	
7/16" - 14 NC	.3897	.3897	.3911	.3911	.3911	.3911	.3911	.3911	.3911	.3911	
	.3826	.3850	.3876	.3862	.3875		.4003	.3972	.3957	.3960	
7/16" - 20 NF	.4037	.4037	.4050	.4050	.4050	.4050	.4050	.4050	.4050	.4050	
	.3975	.3995	.4019	.4014	.4024		.4131	.4104	.4091	.4086	
7/16" - 28 NEF	.4132	.4143	.4143	.4143	.4143	.4143	.4143	.4143	.4143	.4143	
	.4096	.4116	.4107	.4118			.4189	.4178	.4179	.4168	
1/2" - 13 NC	.4485	.4485	.4500	.4500	.4500	.4500	.4500	.4500	.4500	.4500	
	.4411	.4435	.4463	.4448	.4463		.4597	.4565	.4548	.4552	
1/2" - 20 NF	.4662	.4662	.4675	.4675	.4675	.4675	.4675	.4675	.4675	.4675	
	.4598	.4619	.4643	.4639	.4649		.4759	.4731	.4717	.4711	
1/2" - 28 NEF	.4757	.4768	.4768	.4768	.4768	.4768	.4768	.4768	.4768	.4768	
	.4720	.4740	.4731	.4742			.4816	.4804	.4805	.4794	



## TABLE OF THREAD PITCH DIAMETER LIMITS

Nominal Size Threads Per Inch and Series	Thread Ring Gages (External Threads)					Basic P.D.	Thread Plug Gages (Internal Threads)					
	Unified Series		National Series	National Series			Unified Series		National Series			
	1A	2A		3A	2		3	1B	2B	3B	2	3
9/16" - 12 NC	.5068	.5068	.5084	.5084	.5084	.5084	.5084	.5084	.5084	.5084	.5084	.5084
	.4990	.5016	.5045	.5028	.5044		.5186	.5152	.5135	.5140	.5124	
9/16" - 18 NF	.5250	.5250	.5264	.5264	.5264	.5264	.5264	.5264	.5264	.5264	.5264	.5264
	.5182	.5205	.5230	.5223	.5234		.5353	.5323	.5308	.5305	.5294	
9/16" - 24 NEF		.5342	.5354	.5354	.5354	.5354		.5354	.5354	.5354	.5354	.5354
		.5303	.5325	.5314	.5326			.5405	.5392	.5394	.5382	
5/8" - 11 NC	.5644	.5644	.5660	.5660	.5660	.5660	.5660	.5660	.5660	.5660	.5660	.5660
	.5561	.5589	.5619	.5601	.5618		.5767	.5732	.5714	.5719	.5702	
5/8" - 18 NF	.5875	.5875	.5889	.5889	.5889	.5889	.5889	.5889	.5889	.5889	.5889	.5889
	.5805	.5828	.5854	.5848	.5859		.5980	.5949	.5934	.5930	.5919	
5/8" - 24 NEF		.5967	.5979	.5979	.5979	.5979		.5979	.5979	.5979	.5979	.5979
		.5927	.5949	.5938	.5950			.6031	.6018	.6020	.6008	
11/16" - 24 NEF		.6592	.6604	.6604	.6604	.6604		.6604	.6604	.6604	.6604	.6604
		.6552	.6574	.6563	.6575			.6656	.6643	.6645	.6633	
3/4" - 10 NC	.6832	.6832	.6850	.6850	.6850	.6850	.6850	.6850	.6850	.6850	.6850	.6850
	.6744	.6773	.6806	.6786	.6805		.6965	.6927	.6907	.6914	.6895	
3/4" - 16 NF	.7079	.7079	.7094	.7094	.7094	.7094	.7094	.7094	.7094	.7094	.7094	.7094
	.7004	.7029	.7056	.7049	.7062		.7192	.7159	.7143	.7139	.7126	
3/4" - 20 NEF		.7162	.7175	.7175	.7175	.7175		.7175	.7175	.7175	.7175	.7175
		.7118	.7142	.7129	.7143			.7232	.7218	.7221	.7207	
13/16" - 20 NS		.7787	.7800	.7800	.7800	.7800		.7800	.7800	.7800	.7800	.7800
		.7743	.7767	.7754	.7768			.7857	.7843	.7846	.7832	
7/8" - 9 NC	.8009	.8009	.8028	.8028	.8028	.8028	.8028	.8028	.8028	.8028	.8028	.8028
	.7914	.7946	.7981	.7958	.7979		.8151	.8110	.8089	.8098	.8077	
7/8" - 14 NF	.8270	.8270	.8286	.8286	.8286	.8286	.8286	.8286	.8286	.8286	.8286	.8286
	.8189	.8216	.8245	.8237	.8250		.8392	.8356	.8339	.8335	.8322	
7/8" - 20 NEF		.8412	.8425	.8425	.8425	.8425		.8425	.8425	.8425	.8425	.8425
		.8368	.8392	.8378	.8392			.8482	.8468	.8472	.8458	
15/16" - 20 NS		.9036	.9050	.9050	.9050	.9050		.9050	.9050	.9050	.9050	.9050
		.8991	.9016	.9003	.9017			.9109	.9094	.9097	.9083	
1" - 8 NC	.9168	.9168	.9188	.9188	.9188	.9188	.9188	.9188	.9188	.9188	.9188	.9188
	.9067	.9100	.9137	.9112	.9134		.9320	.9276	.9254	.9264	.9242	
1" - 12 UNF	.9441	.9441	.9459	.9459	.9459	.9459	.9459	.9459	.9459	.9459	.9459	.9459
	.9353	.9382	.9415	.9403	.9419		.9573	.9535	.9516	.9515	.9499	
1" - 20 NEF		.9661	.9675	.9675	.9675	.9675		.9675	.9675	.9675	.9675	.9675
		.9616	.9641	.9627	.9641			.9734	.9719	.9723	.9609	
1-1/16" - 18 NS		1.0250	1.0264	1.0264	1.0264	1.0264		1.0264	1.0264	1.0264	1.0264	1.0264
		1.0203	1.0228	1.0213	1.0228			1.0326	1.0310	1.0315	1.0300	
1-1/8" - 7 NC	1.0300	1.0300	1.0322	1.0322	1.0322	1.0322	1.0322	1.0322	1.0322	1.0322	1.0322	1.0322
	1.0191	1.0228	1.0268	1.0237	1.0263		1.0463	1.0416	1.0393	1.0407	1.0381	
1-1/8" - 12 NF	1.0691	1.0691	1.0709	1.0709	1.0709	1.0709	1.0709	1.0709	1.0709	1.0709	1.0709	1.0709
	1.0601	1.0631	1.0664	1.0653	1.0669		1.0826	1.0787	1.0768	1.0765	1.0749	
1-1/8" - 18 NEF		1.0875	1.0889	1.0889	1.0889	1.0889		1.0889	1.0889	1.0889	1.0889	1.0889
		1.0828	1.0853	1.0837	1.0853			1.0951	1.0935	1.0941	1.0925	
1-3/16" - 18 NEF		1.1499	1.1514	1.1514	1.1514	1.1514		1.1514	1.1514	1.1514	1.1514	1.1514
		1.1450	1.1478	1.1462	1.1478			1.1577	1.1561	1.1566	1.1550	
1-1/4" - 7 NC	1.1550	1.1550	1.1572	1.1572	1.1572	1.1572	1.1572	1.1572	1.1572	1.1572	1.1572	1.1572
	1.1439	1.1476	1.1517	1.1487	1.1513		1.1716	1.1668	1.1644	1.1657	1.1631	
1-1/4" - 12 NF	1.1941	1.1941	1.1959	1.1959	1.1959	1.1959	1.1959	1.1959	1.1959	1.1959	1.1959	1.1959
	1.1849	1.1879	1.1913	1.1903	1.1919		1.2079	1.2039	1.2019	1.2015	1.1999	
1-1/4" - 18 NEF		1.2124	1.2139	1.2139	1.2139	1.2139		1.2139	1.2139	1.2139	1.2139	1.2139
		1.2075	1.2103	1.2086	1.2102			1.2202	1.2186	1.2192	1.2176	
1-5/16" - 18 NEF		1.2749	1.2764	1.2764	1.2764	1.2764		1.2764	1.2764	1.2764	1.2764	1.2764
		1.2700	1.2728	1.2711	1.2727			1.2827	1.2811	1.2817	1.2801	
1-3/8" - 6 NC	1.2643	1.2643	1.2667	1.2667	1.2667	1.2667	1.2667	1.2667	1.2667	1.2667	1.2667	1.2667
	1.2523	1.2563	1.2607	1.2566	1.2596		1.2822	1.2771	1.2745	1.2768	1.2738	
1-3/8" - 12 NF	1.3190	1.3190	1.3209	1.3209	1.3209	1.3209	1.3209	1.3209	1.3209	1.3209	1.3209	1.3209
	1.3096	1.3127	1.3162	1.3153	1.3169		1.3332	1.3291	1.2370	1.3265	1.3249	
1-3/8" - 18 NEF		1.3374	1.3389	1.3389	1.3389	1.3389		1.3389	1.3389	1.3389	1.3389	1.3389
		1.3325	1.3353	1.3335	1.3351			1.3452	1.3436	1.3443	1.3427	
1-7/16" - 18 NEF		1.3999	1.4014	1.4014	1.4014	1.4014		1.4014	1.4014	1.4014	1.4014	1.4014
		1.3949	1.3977	1.3960	1.3976			1.4079	1.4062	1.4068	1.4052	
1-1/2" - 6 NC	1.3893	1.3893	1.3917	1.3917	1.3917	1.3917	1.3917	1.3917	1.3917	1.3917	1.3917	1.3917
	1.3772	1.3812	1.3856	1.3816	1.3846		1.4075	1.4022	1.3996	1.4018	1.3988	
1-1/2" - 12 NF	1.4440	1.4440	1.4459	1.4459	1.4459	1.4459	1.4459	1.4459	1.4459	1.4459	1.4459	1.4459
	1.4344	1.4376	1.4411	1.4403	1.4419		1.4584	1.4542	1.4522	1.4515	1.4499	
1-1/2" - 18 NEF		1.4624	1.4639	1.4639	1.4639	1.4639		1.4639	1.4639	1.4639	1.4639	1.4639
		1.4574	1.1402	1.4584	1.4601			1.4704	1.4687	1.4694	1.4677	





# DECIMAL AND METRIC EQUIVALENTS

Drill Size	Decimal	MM	Drill Size	Decimal	MM	Drill Size	Decimal	MM	Drill Size	Decimal	MM	Drill Size	Decimal	MM
80	0.0135	0.343		0.0538	1.367	28	0.1405	3.569	A	0.2340	5.944	27/64"	0.4219	10.716
79	0.0145	0.368	54	0.0550	1.397	9/64"	0.1406	3.572	15/64"	0.2344	5.953	7/16"	0.4375	11.113
1/64"	0.0156	0.397	53	0.0595	1.511	27	0.1440	3.658	B	0.2380	6.045	29/64"	0.4531	11.509
78	0.0160	0.406		0.0598	1.519	26	0.1470	3.734		0.2391	6.073	15/32"	0.4688	11.906
	0.0164	0.417	1/16"	0.0625	1.588	25	0.1495	3.797	C	0.2420	6.147	31/64"	0.4844	12.303
	0.0179	0.455	52	0.0635	1.613	24	0.1520	3.861	D	0.2460	6.248	1/2"	0.5000	12.700
77	0.0180	0.457	51	0.0670	1.702	23	0.1540	3.912	1/4"	0.2500	6.350	33/64"	0.5156	13.097
76	0.0200	0.508		0.0673	1.709	5/32"	0.1563	3.969	E	0.2500	6.350	17/32"	0.5313	13.494
	0.0209	0.531	50	0.0700	1.778	22	0.1570	3.988	F	0.2570	6.528	35/64"	0.5469	13.891
75	0.0210	0.533	49	0.0730	1.854	21	0.1590	4.039	G	0.2610	6.629	9/16"	0.5625	14.288
74	0.0225	0.572		0.0747	1.897	20	0.1610	4.089	17/64"	0.2656	6.747	37/64"	0.5781	14.684
	0.0239	0.607	48	0.0760	1.930		0.1644	4.176	H	0.2660	6.756	19/32"	0.5938	15.081
73	0.0240	0.610	5/64"	0.0781	1.984	19	0.1660	4.216	I	0.2720	6.909	39/64"	0.6094	15.478
72	0.0250	0.635	47	0.0785	1.994	18	0.1695	4.305	J	0.2770	7.036	5/8"	0.6250	15.875
71	0.0260	0.660	46	0.0810	2.057	11/64"	0.1719	4.366	K	0.2810	7.137	41/64"	0.6406	16.272
	0.0269	0.683	45	0.0820	2.083	17	0.1730	4.394	9/32"	0.2813	7.144	21/32"	0.6563	16.669
70	0.0280	0.711	44	0.0860	2.184	16	0.1770	4.496	L	0.2900	7.366	43/64"	0.6719	17.066
69	0.0292	0.742	43	0.0890	2.261		0.1793	4.554	M	0.2950	7.493	11/16"	0.6875	17.463
	0.0299	0.759		0.0897	2.278	15	0.1800	4.572	19/64"	0.2969	7.541	45/64"	0.7031	17.859
68	0.0310	0.787	42	0.0935	2.375	14	0.1820	4.623	N	0.3020	7.671	23/32"	0.7188	18.256
1/32"	0.0313	0.794	3/32"	0.0938	2.381	13	0.1850	4.699	5/16"	0.3125	7.938	47/64"	0.7344	18.653
67	0.0320	0.813	41	0.0960	2.438	3/16"	0.1875	4.763	O	0.3160	8.026	3/4"	0.7500	19.050
	0.0329	0.836	40	0.0980	2.489	12	0.1890	4.801	P	0.3230	8.204	49/64"	0.7656	19.447
66	0.0330	0.838	39	0.0995	2.527	11	0.1910	4.851	21/64"	0.3281	8.334	25/32"	0.7813	19.844
65	0.0350	0.889	38	0.1015	2.578	10	0.1935	4.915	Q	0.3320	8.433	51/64"	0.7969	20.241
	0.0359	0.912	37	0.1040	2.642		0.1943	4.935	R	0.3390	8.611	13/16"	0.8125	20.638
64	0.0360	0.914		0.1046	2.657	9	0.1960	4.978	11/32"	0.3438	8.731	53/64"	0.8281	21.034
63	0.0370	0.940	36	0.1065	2.705	8	0.1990	5.055	S	0.3480	8.839	27/32"	0.8438	21.431
62	0.0380	0.965	7/64"	0.1094	2.778	7	0.2010	5.105	T	0.3580	9.093	55/64"	0.8594	21.828
61	0.0390	0.991	35	0.1100	2.794	13/64"	0.2031	5.159	23/64"	0.3594	9.128	7/8"	0.8750	22.225
60	0.0400	1.016	34	0.1110	2.819	6	0.2040	5.182	U	0.3680	9.347	57/64"	0.8906	22.622
59	0.0410	1.041	33	0.1130	2.870	5	0.2055	5.220	3/8"	0.3750	9.525	29/32"	0.9063	23.019
	0.0418	1.062	32	0.1160	2.946	4	0.2090	5.309	V	0.3770	9.576	59/64"	0.9219	23.416
58	0.0420	1.067		0.1196	3.038		0.2092	5.314	W	0.3860	9.804	15/16"	0.9375	23.813
57	0.0430	1.092	31	0.1200	3.048	3	0.2130	5.410	25/64"	0.3906	9.922	61/64"	0.9531	24.209
56	0.0465	1.181	1/8"	0.1250	3.175	7/32"	0.2188	5.556	X	0.3970	10.084	31/32"	0.9688	24.606
3/64"	0.0469	1.191	30	0.1285	3.264	2	0.2210	5.613	Y	0.4040	10.262	63/64"	0.9844	25.003
	0.0478	1.214		0.1345	3.416		0.2242	5.695	13/32"	0.4063	10.319	1	1.0000	25.400
55	0.0520	1.321	29	0.1360	3.454	1	0.2280	5.791	Z	0.4130	10.490			

TAP DRILL SIZES							
THREAD	DRILL	THREAD	DRILL	THREAD	DRILL	THREAD	DRILL
0-80	3/64	7/16-14	U	6-40	No. 33	1-8	7/8
1-64	No. 53	7/16-20	W	8-32	No. 29	1-14	15/16
1-72	No. 53	1/2-13	27/64	8-36	No. 29	1-1/8-7	63/64
2-56	No. 51	1/2-20	29/64	10-24	No. 25	1-1/8-12	1-3/64
2-64	No. 50	9/16-12	31/64	10-32	No. 21	1-1/4-7	1-7/64
3-48	No. 47	9/16-18	33/64	12-24	No. 17	1-1/4-12	1-11/64
3-56	No. 46	5/8-11	17/32	12-28	No. 15	1-1/2-6	1-11/32
4-40	No. 43	5/8-18	37/64	1/4-20	No. 7	1-1/2-12	1-27/64
4-48	No. 42	3/4-10	21/32	1/4-28	No. 3	1-3/4-5	1-35/64
5-40	No. 39	3/4-16	11/16	5/16-18	F	1-3/4-12	1-43/64
5-44	No. 37	7/8-9	49/64	5/16-24	I	2 - 4-1/2	1-25-32
6-32	No. 36	7/8-14	13/16	3/8-16	5/16	2-12	1-59-64
6-40	No. 33	1-8	7/8	3/8-24	Q	2-1/4-4-1/2	2-1/32

TAPER PIPE			
THREAD	DRILL	THREAD	DRILL
1/8-27	R	1-1/2-11-1/2	1-47/64
1/4-18	7/16	2-11-1/2	2-7/32
3/8-18	37/64	2-1/2-8	2-5/8
1/2-14	23/32	3-8	3-1/4
3/4-14	59/64	3-1/2-8	3-3/4
1-111/2	1-5/32	4-8	4-1/4
1-1/4-11-1/2	1-1/2		





Meyer branded gages are made in the USA. *Black OX* branded gages are assembled in the USA.



*Complete Customer Satisfaction is our Goal.*